



**Radiant heating & cooling,
plumbing and
local heat distribution**

Uponor

Product Catalogue 03-2022
Multi-layer pipe system



Uponor Uni Pipe PLUS



The Uni Pipe PLUS is Uponor's unique multilayer composite pipe for tap water and heating/cooling application. Its bend radius is up to 40 per cent smaller than current multilayer composite pipes: changes of

direction when installing can be achieved by bending the pipe, reducing fitting requirements and installation time.

Your benefits

- Seamless or OWC-technology for highest level of safety
- High dimensional stability, low expansion rates
- Increased flexibility
- 100% oxygen barrier
- Lightweight



Specification

- Oxygen diffusion resistant multi-layer composite pipe (PE-RT - adhesive – seamless aluminium/longitudinally welded aluminium - adhesive - PE-RT) produced using SACP and OWC-technology.
- Fire classification E according to EN 13501-1.
- With pipe end caps as hygienic seal according EN 806.

Application

- Tested/Approved according EN ISO 21003 Multilayer piping systems for hot and cold water installations inside buildings for application class 1,2,4,5/10bar
- Tap water: The permanent operating temperature ranges from 0°C to 70°C at a maximum permanent operating pressure of 10 bar. The short-term malfunction temperature is 95°C for a period of 100 hours in the operating life time.
- Heating: The permanent operating temperature ranges up to 80°C at a maximum permanent operating pressure of 10 bar. The short-term malfunction temperature is 100°C for a period of 100 hours in the operating life time.

Certification

- Approvals by local OM.
- E.g.
- DVGW
- AENOR

Uponor Uni Pipe PLUS white S

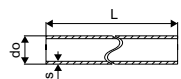

Item no.	Dimension	L do s m mm mm	Qty 2	Qty 1	UOM
1059572	16x2,0 5m	5 16 2,0	125	5	m
1059573	20x2,25 5m	5 20 2,25	85	5	m
1059574	25x2,5 5m	5 25 2,5	50	5	m
1059575	32x3,0 5m	5 32 3	35	5	m

Uponor MLC pipe white S

- bar

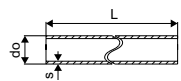

Item no.	Dimension	L do s m mm mm	Qty 2	Qty 1	UOM
1013446	40x4,0 5m	5 40 4	20	5	m
1013449	50x4,5 5m	5 50 4,5	20	5	m
1013451	63x6,0 5m	5 63 6	15	5	m
1013453	75x7,5 5m	5 75 7,5	255	5	m
1013455	90x8,5 5m	5 90 8,5	255	5	m
1013457	110x10,0 5m	5 110 10	165	5	m

Uponor Uni Pipe PLUS

Uponor Uni Pipe PLUS white

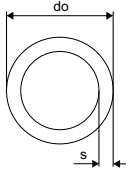

Item no.	Dimension	L m	do mm	s mm	Qty 2	Qty 1	UOM
1059576	16x2,0 100m	100	16	2,0	2000	100	m
1059578	16x2,0 500m	500	16	2,0	3500	500	m

Uponor MLC pipe white

- coil

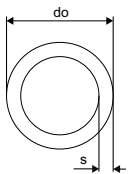

Item no.	Dimension	L m	do mm	s mm	Qty 2	Qty 1	UOM
1013366	14x2,0 200m	200	14	2	2600	200	m

Uponor Uni Pipe PLUS white IPPC

- coil on IPPC palette

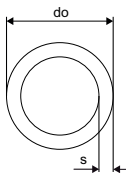

Item no.	Dimension	L m	do mm	s mm	Qty 2	Qty 1	UOM
1084909	16x2,0 200m	200	16	2	2600	200	m
1084910	20x2,25 100m	100	20	2,25	1300	100	m
1084911	25x2,5 50m	50	25	2,5	700	50	m
1084912	32x3,0 50m	50	32	3	400	50	m

Uponor Uni Pipe PLUS

Uponor Uni Pipe PLUS insulated

Specification

- Consists of pipe and insulating layer.
- Supplied in coils.
- pipe insulation made of polyethylene foam with closed-cell material structure.
- With sturdy, seamless foil coating

Uponor Uni Pipe PLUS white insulated S4 WLS 040

- Insulation thickness 4 mm
- thermal conductivity $\lambda=0,040$ W/m*k
- round extruded

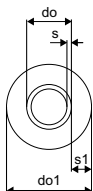

Item no.	Dimension	L m	do mm	do1 mm	s mm	s1 mm	colour	Qty 2	Qty 1	UOM
1063553	16x2,0 blue 100m	100	16	24	2	4	blue	800	100	m
1063555	20x2,25 blue 100m	100	20	28	2,25	4	blue	800	100	m
1063946	25x2,5 blue 50m	50	25	33	2,5	4	blue	400	50	m
1091716	32x3,0 blue 50m	50	32	40	3	4	blue	350	50	m

Uponor Uni Pipe PLUS white insulated S6 WLS 035

- Insulation thickness 6 mm
- thermal conductivity $\lambda=0,035$ W/m*k
- round extruded

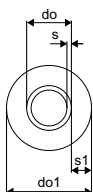

Item no.	Dimension	L m	do mm	do1 mm	s mm	s1 mm	colour	Qty 2	Qty 1	UOM
1063556	16x2,0 blue 75m	75	16	28	2	6	blue	600	75	m
1063557	20x2,25 blue 75m	75	20	32	2,25	6	blue	600	75	m
1063558	25x2,5 blue 50m	50	25	37	2,5	6	blue	400	50	m

Uponor Uni Pipe PLUS white insulated S6 WLS 040

- Insulation thickness 6 mm
- thermal conductivity $\lambda=0,040$ W/m*k
- round extruded

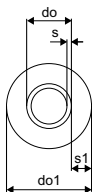

Item no.	Dimension	L m	do mm	do1 mm	s mm	s1 mm	colour	Qty 2	Qty 1	UOM
1091723	16x2,0 blue 75m	75	16	28	2	6	blue	600	75	m
1091724	20x2,25 blue 75m	75	20	32	2,25	6	blue	600	75	m
1091725	25x2,5 blue 50m	50	25	37	2,5	6	blue	400	50	m

Uponor Uni Pipe PLUS

Uponor Uni Pipe PLUS white insulated S10 WLS 035

- Insulation thickness 10 mm
- thermal conductivity $\lambda=0,035 \text{ W/m}\cdot\text{k}$
- round extruded

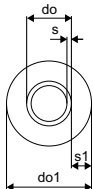

Item no.	Dimension	L m	do mm	do1 mm	s mm	s1 mm	colour	Qty 2	Qty 1	UOM
1062181	16x2,0 blue 75m	75	16	36	2	10	blue	450	75	m
1062182	20x2,25 blue 75m	75	20	40	2,25	10	blue	525	75	m
1062183	25x2,5 blue 50m	50	25	45	2,5	10	blue	350	50	m

Uponor Uni Pipe PLUS in conduit

Specification

- pipe in conduit pipe
- Supplied in coils.
- conduit pipe corrugated made of HDPE

Uponor Uni Pipe PLUS white in conduit

- pipe in conduit

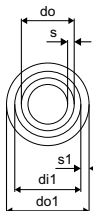

Item no.	Dimension	L m	di1 mm	do mm	do1 mm	s mm	colour	Qty 2	Qty 1	UOM
1063061	16x2,0 - 25/20 red 75m	75	20	16	25	2,0	red	1125	75	m
1063059	16x2,0 - 25/20 blue 75m	75	20	16	25	2,0	blue	1125	75	m
1063062	20x2,25 - 28/23 red 75m	75	23	20	28	2,25	red	900	75	m
1063060	20x2,25 - 28/23 blue 75m	75	23	20	28	2,25	blue	900	75	m

Uponor Teck

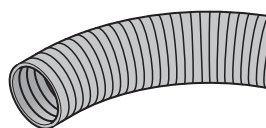

Uponor Teck are conduit pipes designed to protect the interior of flexible multilayer pipes used for tap water and heating/cooling application.

Your benefits

- Ensures safe and secure water supply
- Certified quality
- Protects inner pipe
- Colour coding for hot and cold water



Specification

- Corrugated, made of high density polyethylene (HDPE)
- Fire classification E according to EN 13501-1
- Supplied in coils.

Application

- Used for pipe in pipe (PIP) installations to reduce the risk for water damages and allow for flexible media pipe to be replaced

Uponor Teck conduit black

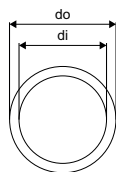

Item no.	Dimension	L m	di mm	do mm	colour	Qty 2	Qty 1	UOM
1012860	25/20 50m	50	20	25	black	2500	50	m
1012864	28/23 50m	50	23	28	black	2000	50	m
1012869	35/29 50m	50	29	35	black	1400	50	m
1012872	43/36 25m	25	36	43	black	600	25	m
1023127*	54/48 25m	25	48	54	black	600	25	m

Uponor Teck conduit blue

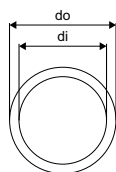

Item no.	Dimension	L m	di mm	do mm	colour	Qty 2	Qty 1	UOM
1012859	25/20 50m	50	20	25	blue	2500	50	m
1012863	28/23 50m	50	23	28	blue	2000	50	m
1012867	35/29 50m	50	29	35	blue	1400	50	m

Uponor Teck conduit red

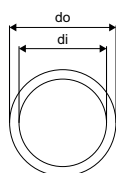

Item no.	Dimension	L m	di mm	do mm	colour	Qty 2	Qty 1	UOM
1012858	25/20 50m	50	20	25	red	2500	50	m
1012862	28/23 50m	50	23	28	red	2000	50	m
1012866	35/29 50m	50	29	35	red	1400	50	m

Uponor Uni

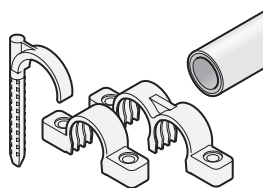

Uponor Uni brings together all accessories needed for installing the multilayer pipe systems.

Your benefits

- Quick installation
- Full range of accessories
- Easy to use



Uponor Teck single plugged hook

- for fixing pipes up to a max. outside diameter of 32 mm to the raw concrete ceiling
- Made of plastic
- Colour: blue
- Drill hole 8 mm



Item no.	Dimension	l mm	l1 mm	di mm	do mm	Qty 2	Qty 1	UOM
1013137	32 60mm	60	20	32	8	1000	50	pce
1013138	32 80mm	80	20	32	8	1000	50	pce

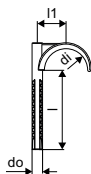

Uponor Teck double plugged hook

- for fixing pipes up to a max. outside diameter of 32 mm to the raw concrete ceiling
- Made of plastic
- Colour: blue
- Drill hole 8 mm



Item no.	Dimension	l mm	di mm	do mm	k mm	Qty 2	Qty 1	UOM
1013139	32 60mm	60	32	8	40	1000	50	pce
1013140	32 80mm	80	32	8	40	1000	50	pce

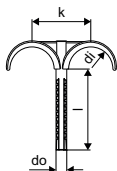

Uponor Uni

Uponor Uni pipe clamps

Uponor MLC pipe clip white

- Easy opening with screwdriver
- Connectable up to 25 mm.

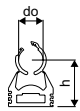

Item no.	Dimension	Qty 2	Qty 1	UOM
1013142	16	20400	100	pce
1013144	20	10200	50	pce
1013145	25	10200	50	pce
1013146	32	500	50	pce
1013147	40	500	25	pce

Uponor S-Press PLUS

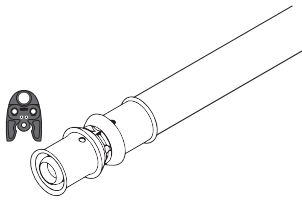

S-Press PLUS/ S-Press, our new generation of press fittings, is the perfect solution for ensuring permanently tight pipe connections. It's 100% backward compatible with current Uponor composite pipes and tools.

Available in dimensions from 14 to 75 mm in both metal and plastic, S-Press PLUS/ S-Press are the fittings that knows no compromise.

Your benefits

- **TOUGH:** Withstand harshest conditions
- **SAFE:** Ensuring your perfect pressing result
- **EASY:** Simplifying planning and installation
- **SMART:** Answering all your questions on site



Specification

- Fixed press sleeve with inspection window
- Precise jaw fixation
- Fast diameter recognition
- Accurate test safety function
- 100% backward compatible with existing Uponor components
- Flow rate optimized fitting body

Application

- Tap water: The permanent operating temperature ranges from 0°C to 70°C at a maximum permanent operating pressure of 10 bar. The short-term malfunction temperature is 95°C for a period of 100 hours in the operating life time.
- Heating: The permanent operating temperature ranges up to 80°C at a maximum permanent operating pressure of 10 bar. The short-term malfunction temperature is 100°C for a period of 100 hours in the operating life time.

if not different mentioned:

- Male and female threads acc.to EN 10226-1.

Certification

- Approvals by local OM.

E.g.

- DVGW
- AENOR

Uponor S-Press PLUS/ S-Press made of PPSU

Specification

- made of PPSU

Uponor S-Press PLUS

Uponor S-Press PLUS elbow PPSU

- Unique press indicator
- Fast 3-step installation (press without bevel)
- Innovative QR code for immediate digital access
- Colour code

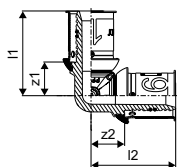

Item no.	Dimension	l1 mm	l2 mm	z1 mm	z2 mm	Qty 2	Qty 1	UOM
1039929	16-16	33	33	13	13	80	20	pce
1039930	20-20	37	37	16	16	80	10	pce
1039931	25-25	48	48	19	19	80	10	pce
1039932	32-32	51	51	23	23	20	5	pce

Uponor S-Press composite elbow PPSU

- Fast installation with easy bevel and without calibration
- Colour code

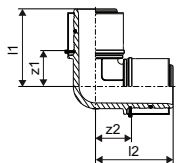

Item no.	Dimension	l1 mm	l2 mm	z1 mm	z2 mm	Qty 2	Qty 1	UOM
1046386	40-40	68	68	29	29	960	5	pce
1046387	50-50	73	73	34	34	576	3	pce
1032877	63-63	101	101	40	40	210	1	pce
1032878	75-75	108	108	47	47	210	1	pce

Uponor S-Press composite elbow 45° PPSU

- Fast installation with easy bevel and without calibration
- Colour code

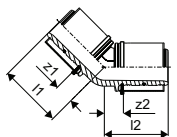

Item no.	Dimension	l1 mm	l2 mm	z1 mm	z2 mm	Qty 2	Qty 1	UOM
1046388	40-40	56	56	17	17	960	5	pce
1046389	50-50	59	59	20	20	576	3	pce
1032879	63-63	83	83	23	23	192	1	pce
1032880	75-75	86	86	25	25	192	1	pce

Uponor S-Press PLUS

Uponor S-Press PLUS coupling PPSU

- Unique press indicator
- Fast 3-step installation (press without bevel)
- Innovative QR code for immediate digital access
- Colour code

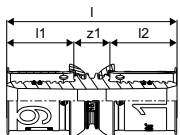

Item no.	Dimension	l mm	l1 mm	l2 mm	z1 mm	Qty 2	Qty 1	UOM
1039933	16-16	51	20	20	11	80	20	pce
1039934	20-20	54	21	21	11	80	10	pce
1039935	25-25	68	28	28	11	80	10	pce
1039936	32-32	69	28	28	13	80	10	pce

Uponor S-Press composite coupling PPSU

- Fast installation with easy bevel and without calibration
- Colour code

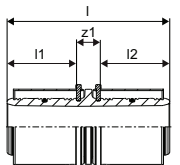

Item no.	Dimension	l mm	l1 mm	l2 mm	z1 mm	Qty 2	Qty 1	UOM
1046401	40-40	91	39	39	13	960	5	pce
1046402	50-50	91	39	39	13	576	3	pce
1032881	63-63	137	61	61	15	384	1	pce
1032882	75-75	137	61	61	15	384	1	pce

Uponor S-Press PLUS reducer PPSU

- Unique press indicator
- Fast 3-step installation (press without bevel)
- Innovative QR code for immediate digital access
- Colour code

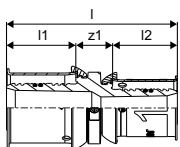

Item no.	Dimension	l mm	l1 mm	l2 mm	z1 mm	Qty 2	Qty 1	UOM
1039937	20-16	53	21	20	11	80	20	pce
1039938	25-16	60	28	20	11	80	10	pce
1039939	25-20	61	28	21	11	80	10	pce
1039940	32-25	69	28	28	13	80	10	pce

Uponor S-Press PLUS

Uponor S-Press reducer PPSU

- Fast installation with easy bevel and without calibration
- Colour code

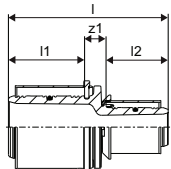
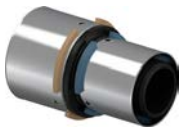

Item no.	Dimension	l mm	l1 mm	l2 mm	z1 mm	Qty 2	Qty 1	UOM
1039941	40-25	80	39	28	12	960	5	pce
1039942	40-32	80	39	28	13	960	5	pce
1039943	50-32	80	39	28	13	1152	3	pce
1046406	50-40	91	39	39	13	576	3	pce
1032883	63-40	115	61	37	17	384	1	pce
1032884	63-50	115	61	37	17	384	1	pce
1032885	75-50	115	61	37	17	384	1	pce
1032886	75-63	137	61	59	17	384	1	pce

Uponor S-Press PLUS tee PPSU

- Unique press indicator
- Fast 3-step installation (press without bevel)
- Innovative QR code for immediate digital access
- Colour code

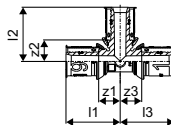

Item no.	Dimension	l1 mm	l2 mm	l3 mm	z1 mm	z2 mm	z3 mm	Qty 2	Qty 1	UOM
1039944	16-16-16	33	33	33	13	13	13	80	10	pce
1039945	20-20-20	37	37	37	16	16	16	80	10	pce
1039946	25-25-25	48	48	48	19	19	19	20	5	pce
1039947	32-32-32	51	51	51	23	23	23	20	5	pce

Uponor S-Press composite tee PPSU

- Fast installation with easy bevel and without calibration
- Colour code

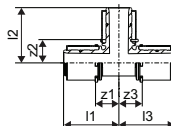

Item no.	Dimension	l1 mm	l2 mm	l3 mm	z1 mm	z2 mm	z3 mm	Qty 2	Qty 1	UOM
1046390	40-40-40	68	68	68	29	29	29	720	5	pce
1046391	50-50-50	73	73	73	33	33	33	288	3	pce
1032887	63-63-63	101	101	101	42	40	42	150	1	pce
1032888	75-75-75	108	107	108	47	47	47	150	1	pce

Uponor S-Press PLUS

Uponor S-Press PLUS tee red. PPSU

- Fixed stainless steel sleeve
- Unique press indicator
- Fast 3-step installation (press without bevel)
- Innovative QR code for immediate digital access
- Colour code

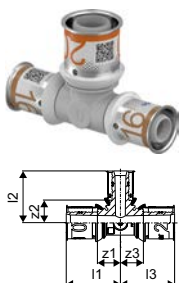

Item no.	Dimension	l1 mm	l2 mm	l3 mm	z1 mm	z2 mm	z3 mm	Qty 2	Qty 1	UOM
1039948	16-20-16	35	35	35	15	13	15	80	10	pce
1039949	20-16-16	37	36	36	16	16	16	80	10	pce
1039950	20-16-20	37	36	37	16	16	16	80	10	pce
1039951	20-20-16	37	37	36	16	16	16	80	10	pce
1039952	20-25-20	41	48	41	19	19	19	80	10	pce
1039953	25-16-16	48	39	39	19	19	19	80	10	pce
1039954	25-16-20	48	39	41	19	19	19	80	10	pce
1039955	25-16-25	48	39	48	19	19	19	80	10	pce
1039956	25-20-20	48	41	41	19	19	19	80	10	pce
1039957	25-20-25	48	41	48	19	19	19	80	10	pce
1039958	32-16-32	51	43	51	23	23	23	20	5	pce
1039959	32-20-32	51	44	51	23	23	23	20	5	pce
1039960	32-25-25	51	51	51	23	23	23	20	5	pce
1039961	32-25-32	51	51	51	23	23	23	20	5	pce

Uponor S-Press tee red. PPSU

- Fast installation with easy bevel and without calibration
- Colour code

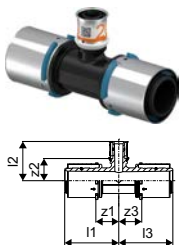

Item no.	Dimension	l1 mm	l2 mm	l3 mm	z1 mm	z2 mm	z3 mm	Qty 2	Qty 1	UOM
1039962	40-20-40	68	49	68	29	28	29	960	5	pce
1039963	40-25-32	68	56	56	29	28	28	960	5	pce
1039964	40-25-40	68	56	68	29	28	29	720	5	pce
1039965	40-32-32	68	56	56	29	28	28	960	5	pce
1039966	40-32-40	68	56	68	29	28	29	720	5	pce
1039967	50-25-40	73	61	73	34	33	34	432	3	pce
1039968	50-25-50	73	61	73	34	33	34	432	3	pce
1039969	50-32-50	73	61	73	34	33	34	432	3	pce

Uponor S-Press composite tee reducer PPSU

- Fast installation with easy bevel and without calibration
- Colour code

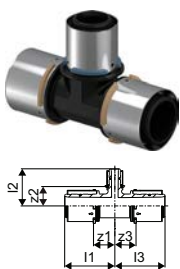

Item no.	Dimension	l1 mm	l2 mm	l3 mm	z1 mm	z2 mm	z3 mm	Qty 2	Qty 1	UOM
1046400	50-40-50	73	73	73	33	33	33	288	3	pce
1032889	63-25-63	101	68	101	40	39	40	150	1	pce
1032890	63-32-63	101	68	101	40	39	40	150	1	pce
1032891	63-40-63	101	79	101	40	40	40	150	1	pce
1032892	75-32-75	108	74	108	47	45	47	150	1	pce
1032893	75-40-75	108	86	108	47	44	47	150	1	pce
1032894	75-50-75	108	86	108	47	49	47	150	1	pce

Uponor S-Press PLUS

Uponor S-Press 14 mm

Specification

- made of tin-plated brass
- Contoured Aluminium-sleeve
- Fast 3-step installation (press without bevel)
- Colour code

Uponor S-Press coupling

Made of tin-plated brass

Contoured Aluminium-sleeve

Fast 3-step installation (press without bevel)

Colour code

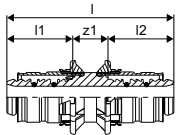

Item no.	Dimension	l	l1	l2	z1	Qty 2	Qty 1	UOM
		mm	mm	mm	mm			
1015154	14-14	54	21	21	11	80	10	pce

Uponor S-Press PLUS

Specification

- made of tin-plated DR brass

Uponor S-Press PLUS adapter male thread

- Unique press indicator
- Fast 3-step installation (press without bevel)
- Innovative QR code for immediate digital access

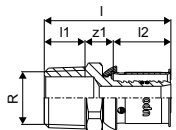

Item no.	Dimension	l	l1	l2	R	z1	Qty 2	Qty 1	UOM
		mm	mm	mm	inch	mm			
1070502	16-R $\frac{1}{2}$ "MT	44	14	20	$\frac{1}{2}$	10	80	20	pce
1070503	16-R $\frac{3}{4}$ "MT	46	16	20	$\frac{3}{4}$	11	120	15	pce
1070504	20-R $\frac{1}{2}$ "MT	45	14	21	$\frac{1}{2}$	10	80	20	pce
1070505	20-R $\frac{3}{4}$ "MT	48	15	21	$\frac{3}{4}$	11	80	10	pce
1070506	20-R1"MT	54	17	21	1	16	80	10	pce
1070507	25-R $\frac{3}{4}$ "MT	55	15	28	$\frac{3}{4}$	11	80	10	pce
1070508	25-R1"MT	62	18	28	1	16	40	5	pce
1070509	32-R1"MT	62	17	28	1	16	40	5	pce
1070510	32-R1 $\frac{1}{4}$ "MT	66	19	28	1 $\frac{1}{4}$	19	20	5	pce

Uponor S-Press PLUS

Uponor S-Press adapter male thread

- Made of tin-plated brass
- Fast installation with easy bevel and without calibration
- Colour code

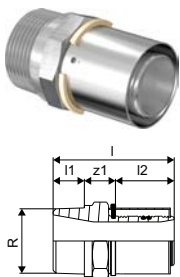

Item no.	Dimension	l mm	l1 mm	l2 mm	R inch	z1 mm	d mm	Qty 2	Qty 1	UOM
1046901	40-R1 ¼"MT	78	20	38	1 ¼	20		960	5	pce
1046902	40-R1 ½"MT	80	20	38	1 ½	22	40	960	5	pce
1046905	50-R1 ½"MT	80	20	38	1 ½	22	50	1152	3	pce
1046906	50-R2"MT	84	24	38	2	22	50	576	3	pce
1032895	63-R2"MT	111	28	61	2	22		336	1	pce
1032896	75-R2 ½"MT	110	27	61	2 ½	22		336	1	pce

Uponor S-Press PLUS adapt. female thread

- Unique press indicator
- Fast 3-step installation (press without bevel)
- Innovative QR code for immediate digital access

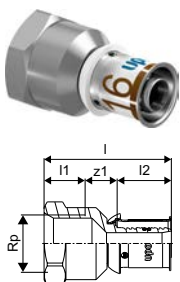

Item no.	Dimension	l mm	l1 mm	l2 mm	Rp inch	z1 mm	Qty 2	Qty 1	UOM
1070515	16-Rp½"FT	47	15	20	½	12	80	20	pce
1070516	20-Rp½"FT	47	15	21	½	10	120	15	pce
1070517	20-Rp¾"FT	51	16	21	¾	14	80	10	pce
1070518	20-Rp1"FT	52	19	21	1	12	80	20	pce
1070519	25-Rp¾"FT	56	17	28	¾	11	40	5	pce
1070520	25-Rp1"FT	59	19	28	1	12	40	5	pce
1070521	32-Rp1"FT	58	20	28	1	10	40	5	pce
1070522	32-Rp1 ¼"FT	62	21	28	1 ¼	13	20	5	pce

Uponor S-Press adapter female thread

- Made of tin-plated brass
- Fast installation with easy bevel and without calibration
- Colour code

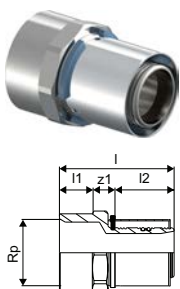

Item no.	Dimension	l mm	l1 mm	l2 mm	Rp inch	z1 mm	Qty 2	Qty 1	UOM
1046903	40-Rp1 ¼"FT	73	21	38	1 ¼	14	960	5	pce
1046904	40-Rp1 ½"FT	77	21	38	1 ½	18	960	5	pce
1046907	50-Rp1 ½"FT	73	21	38	1 ½	14	1152	3	pce

Uponor S-Press PLUS

Uponor S-Press PLUS elbow

- Unique press indicator
- Fast 3-step installation (press without bevel)
- Innovative QR code for immediate digital access



Item no.	Dimension	l1 mm	l2 mm	z1 mm	z2 mm	Qty 2	Qty 1	UOM
1070523	16-16	34	34	14	14	80	20	pce
1070524	20-20	37	37	16	16	80	10	pce
1070525	25-25	47	47	19	19	40	5	pce
1070526	32-32	51	51	23	23	20	5	pce

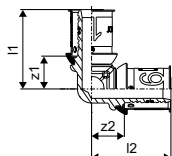

Uponor S-Press elbow

- Made of tin-plated brass
- Fast installation with easy bevel and without calibration
- Colour code



Item no.	Dimension	l1 mm	l2 mm	z1 mm	z2 mm	Qty 2	Qty 1	UOM
1046908	40-40	72	72	34	34	600	5	pce
1046911	50-50	79	79	41	41	240	3	pce

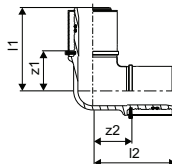

Uponor S-Press PLUS bend

- Made of casted DR brass
- Unique press indicator
- Fast 3-step installation (press without bevel)
- Innovative QR code for immediate digital access
- extra low pressure loss



Item no.	Dimension	l1 mm	l2 mm	z1 mm	z2 mm	Qty 2	Qty 1	UOM
1070527	16-16	37	37	17	17	80	10	pce
1070528	20-20	40	40	19	19	80	10	pce
1070529	25-25	50	50	22	22	40	5	pce
1070530	32-32	56	56	28	28	20	5	pce

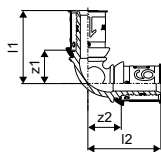

Uponor S-Press PLUS

Uponor S-Press PLUS elbow male thread

- Unique press indicator
- Fast 3-step installation (press without bevel)
- Innovative QR code for immediate digital access

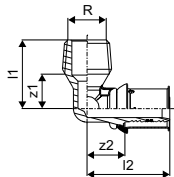

Item no.	Dimension	l1 mm	l2 mm	R inch	z1 mm	z2 mm	Qty 2	Qty 1	UOM
1070532	16-R½"MT	30	37	½	15	17	80	20	pce
1070533	20-R½"MT	32	41	½	15	19	80	10	pce
1070534	20-R¾"MT	34	41	¾	18	19	80	10	pce
1070535	25-R¾"MT	36	48	¾	20	19	40	5	pce
1070536	25-R1"MT	43	51	1	22	23	40	5	pce
1070537	32-R1"MT	43	51	1	22	23	20	5	pce

Uponor S-Press elbow adapter male thread

- Made of tin-plated brass
- Fast installation with easy bevel and without calibration
- Colour code

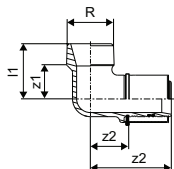

Item no.	Dimension	l1 mm	l2 mm	R inch	z1 mm	z2 mm	Qty 2	Qty 1	UOM
1046909	40-R1 ¼"MT	49	72	1 ¼	30	34	500	5	pce

Uponor S-Press PLUS elbow female thread

- Unique press indicator
- Fast 3-step installation (press without bevel)
- Innovative QR code for immediate digital access

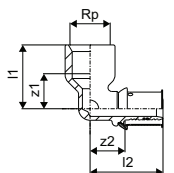

Item no.	Dimension	l1 mm	l2 mm	Rp inch	z1 mm	z2 mm	Qty 2	Qty 1	UOM
1070539	16-Rp½"FT	33	38	½	18	18	80	10	pce
1070540	20-Rp½"FT	36	41	½	21	19	80	10	pce
1070541	20-Rp¾"FT	36	43	¾	19	22	40	10	pce
1070542	25-Rp¾"FT	40	50	¾	23	22	20	5	pce
1070543	25-Rp1"FT	45	54	1	25	26	20	5	pce
1070544	32-Rp1"FT	49	54	1	30	26	20	5	pce

Uponor S-Press PLUS

Uponor S-Press elbow adap. female thread

- Made of tin-plated brass
- Fast installation with easy bevel and without calibration
- Colour code

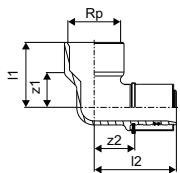

Item no.	Dimension	l1 mm	l2 mm	Rp inch	z1 mm	z2 mm	Qty 2	Qty 1	UOM
1046910	40-Rp1 ½"FT	59	75	1 ½	38	37	500	5	pce
1046912	50-Rp1 ½"FT	59	79	1 ½	38	41	300	3	pce

Uponor S-Press PLUS elbow 45

- Unique press indicator
- Fast 3-step installation (press without bevel)
- Innovative QR code for immediate digital access

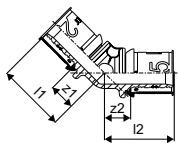

Item no.	Dimension	l1 mm	l2 mm	z1 mm	z2 mm	Qty 2	Qty 1	UOM
1070545	25-25	46	46	18	18	20	5	pce
1070546	32-32	49	49	23	23	20	5	pce

Uponor S-Press elbow 45

- Made of tin-plated brass
- Fast installation with easy bevel and without calibration
- Colour code

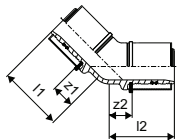

Item no.	Dimension	l1 mm	l2 mm	z1 mm	z2 mm	Qty 2	Qty 1	UOM
1046913	40-40	59	59	21	21	500	5	pce
1046914	50-50	63	63	25	25	300	3	pce

Uponor S-Press PLUS

Uponor S-Press PLUS coupling

- Unique press indicator
- Fast 3-step installation (press without bevel)
- Innovative QR code for immediate digital access

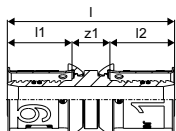

Item no.	Dimension	l mm	l1 mm	l2 mm	z1 mm	Qty 2	Qty 1	UOM
1070547	16-16	51	20	20	12	80	20	pce
1070548	20-20	54	21	21	12	80	10	pce
1070549	25-25	68	28	28	12	80	10	pce
1070550	32-32	68	28	28	12	40	5	pce

Uponor S-Press coupling

- Made of tin-plated brass
- Fast installation with easy bevel and without calibration
- Colour code

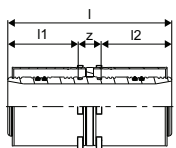

Item no.	Dimension	l mm	l1 mm	l2 mm	z1 mm	Qty 2	Qty 1	UOM
1046932	40-40	88	38	38	12	960	5	pce
1046935	50-50	88	38	38	12	576	3	pce

Uponor S-Press PLUS reducer

- Unique press indicator
- Fast 3-step installation (press without bevel)
- Innovative QR code for immediate digital access

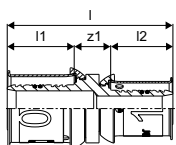

Item no.	Dimension	l mm	l1 mm	l2 mm	z1 mm	Qty 2	Qty 1	UOM
1070552	20-16	53	21	20	12	80	20	pce
1070553	25-16	60	28	20	12	80	10	pce
1070554	25-20	61	28	21	12	80	10	pce
1070555	32-20	61	28	21	12	80	10	pce
1070556	32-25	68	28	28	12	80	10	pce

Uponor S-Press PLUS

Uponor S-Press reducer

- Made of tin-plated brass

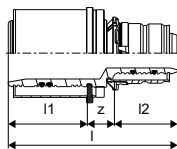

Item no.	Dimension	l mm	l1 mm	l2 mm	z1 mm	Qty 2	Qty 1	UOM
1046930	40-25	81	38	30	13	960	5	pce
1046931	40-32	81	38	30	13	960	5	pce
1046933	50-32	81	38	30	13	1152	3	pce
1046934	50-40	89	38	38	14	576	3	pce

Uponor S-Press PLUS tee

- Unique press indicator
- Fast 3-step installation (press without bevel)
- Innovative QR code for immediate digital access

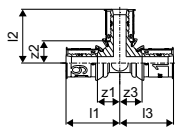

Item no.	Dimension	l1 mm	l2 mm	l3 mm	z1 mm	z2 mm	z3 mm	Qty 2	Qty 1	UOM
1070560	16-16-16	34	34	34	14	14	14	80	10	pce
1070561	20-20-20	37	37	37	16	16	16	80	10	pce
1070562	25-25-25	47	47	47	19	19	19	20	5	pce
1070563	32-32-32	51	51	51	23	23	23	20	5	pce

Uponor S-Press tee

- Made of tin-plated brass
- Fast installation with easy bevel and without calibration
- Colour code

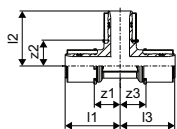

Item no.	Dimension	l1 mm	l2 mm	l3 mm	z1 mm	z2 mm	z3 mm	Qty 2	Qty 1	UOM
1046921	40-40-40	72	72	72	34	34	34	400	5	pce
1046928	50-50-50	79	79	79	41	41	41	300	3	pce

Uponor S-Press PLUS

Uponor S-Press PLUS tee reducer

- Unique press indicator
- Fast 3-step installation (press without bevel)
- Innovative QR code for immediate digital access

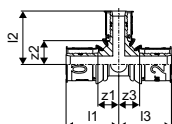

Item no.	Dimension	l1 mm	l2 mm	l3 mm	z1 mm	z2 mm	z3 mm	Qty 2	Qty 1	UOM
1070566	16-20-16	36	37	36	16	16	16	80	10	pce
1070567	20-16-16	35	36	34	14	16	14	40	10	pce
1070568	20-16-20	35	36	35	14	16	14	80	20	pce
1070569	20-20-16	37	37	36	16	16	16	80	20	pce
1070570	20-25-16	40	47	38	19	19	19	40	10	pce
1070571	20-25-20	40	47	40	19	19	19	40	10	pce
1070572	25-16-16	44	38	36	16	19	17	40	5	pce
1070573	25-16-20	44	38	38	16	19	17	40	5	pce
1070574	25-16-25	42	38	42	14	19	14	20	5	pce
1070575	25-20-16	44	40	36	16	19	17	40	5	pce
1070576	25-20-20	44	40	38	16	19	17	40	5	pce
1070577	25-20-25	44	40	44	16	19	16	20	5	pce
1070578	25-25-16	47	47	38	19	19	19	20	5	pce
1070579	25-32-25	50	48	50	22	20	22	20	5	pce
1070580	32-16-32	43	42	43	15	22	15	20	5	pce
1070581	32-20-32	45	43	45	17	22	17	20	5	pce
1070582	32-25-25	48	50	48	20	22	20	20	5	pce
1070583	32-25-32	48	50	48	20	22	20	20	5	pce

Uponor S-Press tee reducer

- Made of tin-plated brass
- Fast installation with easy bevel and without calibration
- Colour code

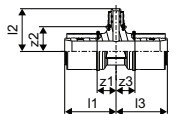

Item no.	Dimension	l1 mm	l2 mm	l3 mm	z1 mm	z2 mm	z3 mm	Qty 2	Qty 1	UOM
1046916	40-20-40	60	50	60	22	28	22	400	5	pce
1046917	40-25-32	61	60	53	23	30	23	500	5	pce
1046918	40-25-40	61	60	61	23	30	23	400	5	pce
1046919	40-32-32	65	60	57	27	30	26	400	5	pce
1046920	40-32-40	65	60	65	27	30	27	400	5	pce
1046924	50-25-40	61	65	61	23	35	23	300	3	pce
1046925	50-25-50	61	65	61	23	35	23	240	3	pce
1046926	50-32-50	65	65	65	27	35	27	300	3	pce
1046927	50-40-50	72	79	72	34	41	34	300	3	pce

Uponor S-Press PLUS

Uponor S-Press PLUS tee male thread

- Unique press indicator
- Fast 3-step installation (press without bevel)
- Innovative QR code for immediate digital access

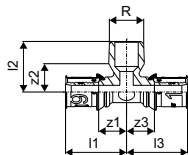

Item no.	Dimension	l1 mm	l2 mm	l3 mm	R inch	z1 mm	z2 mm	z3 mm	Qty 2	Qty 1	UOM
1070592	16-R $\frac{1}{2}$ "MT-16	38	30	38	$\frac{1}{2}$	18	15	18	40	10	pce
1070593	25-R $\frac{3}{4}$ "MT-25	48	36	48	$\frac{3}{4}$	19	21	19	20	5	pce
1070594	32-R $\frac{3}{4}$ "MT-32	48	40	48	$\frac{3}{4}$	19	25	19	20	5	pce

Uponor S-Press PLUS tee female thread

- Unique press indicator
- Fast 3-step installation (press without bevel)
- Innovative QR code for immediate digital access

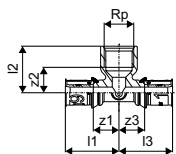

Item no.	Dimension	l1 mm	l2 mm	l3 mm	Rp inch	z1 mm	z2 mm	z3 mm	Qty 2	Qty 1	UOM
1070595	16-Rp $\frac{1}{2}$ "FT-16	38	33	38	$\frac{1}{2}$	18	18	18	40	10	pce
1070596	20-Rp $\frac{1}{2}$ "FT-20	40	35	40	$\frac{1}{2}$	19	20	19	60	15	pce
1070597	20-Rp $\frac{3}{4}$ "FT-20	43	37	43	$\frac{3}{4}$	22	20	22	40	10	pce
1070598	25-Rp $\frac{1}{2}$ "FT-25	48	37	48	$\frac{1}{2}$	19	22	19	20	5	pce
1070599	25-Rp $\frac{3}{4}$ "FT-25	50	40	50	$\frac{3}{4}$	22	23	22	20	5	pce
1070600	32-Rp $\frac{1}{2}$ "FT-32	47	40	47	$\frac{1}{2}$	18	25	18	20	5	pce
1070601	32-Rp $\frac{3}{4}$ "FT-32	51	44	51	$\frac{3}{4}$	23	27	23	20	5	pce

Uponor S-Press tee adapter female thread

- Made of tin-plated brass
- Fast installation with easy bevel and without calibration
- Colour code

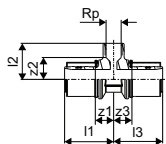

Item no.	Dimension	l1 mm	l2 mm	l3 mm	Rp inch	z1 mm	z2 mm	z3 mm	Qty 2	Qty 1	UOM
1046922	40-Rp $\frac{1}{2}$ "FT-40	69	47	69	$\frac{1}{2}$	31	30	31	500	5	pce
1046923	40-Rp $\frac{3}{4}$ "FT-40	64	47	64	$\frac{3}{4}$	26	31	26	400	5	pce
1046929	50-Rp1"FT-50	72	56	72	1	34	37	34	240	3	pce

Uponor S-Press PLUS

Uponor S-Press PLUS adapter swivel nut

- Unique press indicator
- Fast 3-step installation (press without bevel)
- Innovative QR code for immediate digital access
- Releasable screw connector for connection to on-wall fittings, filters and shut-off valves
- Thread acc. to EN ISO 228-1.

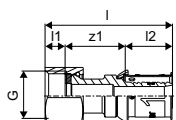

Item no.	Dimension	l mm	l1 mm	l2 mm	G inch	z1 mm	Qty 2	Qty 1	UOM
1070602	16-G $\frac{1}{2}$ "SN	53	8	20	$\frac{1}{2}$	25	30	1	pce
1070603	16-G $\frac{3}{4}$ "SN	44	8	20	$\frac{3}{4}$	17	20	1	pce
1070604	20-G $\frac{1}{2}$ "SN	59	8	21	$\frac{1}{2}$	30	20	1	pce
1070605	20-G $\frac{3}{4}$ "SN	46	8	21	$\frac{3}{4}$	17	20	1	pce
1070606	25-G $\frac{3}{4}$ "SN	64	8	28	$\frac{3}{4}$	28	15	1	pce
1070607	25-G1"SN	57	9	28	1	20	15	1	pce
1070610	32-G1 $\frac{1}{4}$ "SN	59	9	28	1 $\frac{1}{4}$	22	10	1	pce

Uponor S-Press adapter swivel nut

- Made of tin-plated brass
- Fast installation with easy bevel and without calibration
- Colour code
- Releasable screw connector for connection to on-wall fittings, filters and shut-off valves
- Thread acc. to EN ISO 228-1.

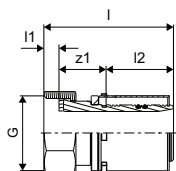

Item no.	Dimension	l mm	l1 mm	l2 mm	G inch	z1 mm	Qty 2	Qty 1	UOM
1046937	40-G1 $\frac{1}{2}$ "SN	77	10	38	$\frac{1}{2}$	30	960	5	pce
1046938	50-G1 $\frac{3}{4}$ "SN	82	12	38	$\frac{3}{4}$	32	1152	3	pce
1046939	50-G2"SN	82	12	38	2	32	576	3	pce

Uponor S-Press PLUS elbow swivel nut

- Unique press indicator
- Fast 3-step installation (press without bevel)
- Innovative QR code for immediate digital access
- Releasable screw connector for connection to on-wall fittings, filters and shut-off valves
- Thread acc. to EN ISO 228-1.

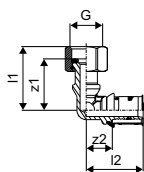

Item no.	Dimension	l1 mm	l2 mm	G inch	z1 mm	z2 mm	Qty 2	Qty 1	UOM
1105818	16-G $\frac{3}{4}$ "SN	45	39	$\frac{3}{4}$	37	19	10	1	pce
1070613	20-G $\frac{1}{2}$ "SN	46	41	$\frac{1}{2}$	39	19	20	1	pce
1105819	20-G $\frac{3}{4}$ "SN	45	41	$\frac{3}{4}$	37	19	10	1	pce

Uponor S-Press PLUS

Uponor S-Press PLUS tap elbow M

- Unique press indicator
- Fast 3-step installation (press without bevel)
- Innovative QR code for immediate digital access
- for on wall installation or attachment with rotation protection to the Uponor Smart Aqua mounting angles and plates.

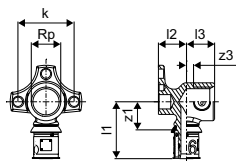

Item no.	Dimension	l1 mm	l2 mm	l3 mm	Rp inch	z1 mm	z3 mm	k mm	Qty 2	Qty 1	UOM
1070638	16-Rp $\frac{3}{8}$ "FT	41	17	22	$\frac{3}{8}$	21	11	40	40	10	pce
1070639	16-Rp $\frac{1}{2}$ "FT	41	17	22	$\frac{1}{2}$	21	7	40	40	10	pce
1070640	20-Rp $\frac{1}{2}$ "FT	42	17	23	$\frac{1}{2}$	21	8	40	40	10	pce
1070641	20-Rp $\frac{3}{4}$ "FT	45	17	23	$\frac{3}{4}$	24	7	40	20	5	pce
1070642	25-Rp $\frac{3}{4}$ "FT	54	27	25	$\frac{3}{4}$	26	8	40	20	5	pce

Uponor S-Press PLUS tap elbow L

- Unique press indicator
- Fast 3-step installation (press without bevel)
- Innovative QR code for immediate digital access
- for on wall installation or attachment with rotation protection to the Uponor Smart Aqua mounting angles and plates.

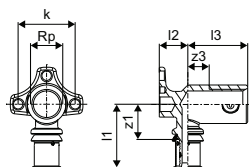

Item no.	Dimension	l1 mm	l2 mm	l3 mm	Rp inch	z1 mm	z3 mm	k mm	Qty 2	Qty 1	UOM
1070644	16-Rp $\frac{1}{2}$ "FT	42	20	30	$\frac{1}{2}$	22	15	40	40	10	pce
1070645	20-Rp $\frac{1}{2}$ "FT	46	20	30	$\frac{1}{2}$	25	15	40	40	10	pce

Uponor S-Press PLUS sound + leak protect

- Set is suitable for two Uponor S-Press PLUS tap elbows 16-Rp $\frac{1}{2}$ "FT or 20-Rp $\frac{1}{2}$ "FT
- Pins and screws M6 x 16 included
- Made of EPP
- Sound protection acc., VDI 4100
- Drainage function conform to DIN 18534



NEW

Item no.	Dimension	l1 mm	l2 mm	z1 mm	Qty 2	Qty 1	UOM
1121193	16-20	20	74	3	192	1	set

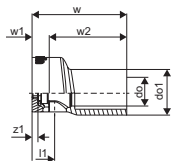

Uponor S-Press PLUS

Uponor S-Press PLUS U-tap elbow

- Unique press indicator
- Fast 3-step installation (press without bevel)
- Innovative QR code for immediate digital access
- For on wall installation or attachment with rotation protection to the Uponor Smart Aqua mounting angles and plates.

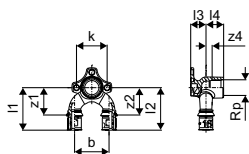

Item no.	Dimension	l1 mm	l2 mm	l3 mm	l4 mm	Rp inch	z1 mm	z2 mm	z4 mm	b mm	k mm	Qty 2	Qty 1	UOM
1070629	16-Rp½"FT-16	56	56	20	23	½	36	36	8	45	40	20	5	pce
1070630	20-Rp½"FT-20	57	57	20	23	½	36	36	8	45	40	960	5	pce
1070631	20-Rp½"FT-16	57	56	20	23	½	36	36	8	45	40	960	5	pce
1070632	16-Rp½"FT-20	56	57	20	23	½	36	36	8	45	40	960	5	pce
1070633	25-Rp½"FT-25	64	64	27	24	½	36	36	9	60	40	576	3	pce
1070634	25-Rp½"FT-20	64	57	27	24	½	36	36	9	60	40	576	3	pce
1070635	20-Rp½"FT-25	57	64	27	24	½	36	36	9	60	40	576	3	pce

Uponor S-Press PLUS sound + leak protect U

- Suitable for one Uponor S-Press PLUS U-tap elbows 16-Rp½"FT or 20-Rp½"FT
- Pins and screws M6 x 16 included
- Made of EPP
- Sound protection acc., VDI 4100
- Drainage function conform to DIN 18534



NEW

Item no.	Dimension	l1 mm	l2 mm	z1 mm	k mm	Qty 2	Qty 1	UOM
1121194	16-20	23	71	3	45	384	1	pce

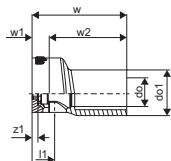

Uponor S-Press PLUS U-tap elbow mixer

- Fixed stainless steel sleeve
- Unique press indicator
- Fast 3-step installation (press without bevel)
- Innovative QR code for immediate digital access
- for inwall mixer and flushing tank connection in serial and loop installation.



Item no.	Dimension	l1 mm	l2 mm	R inch	z1 mm	z2 mm	b mm	Qty 2	Qty 1	UOM
1070636	16-16-R½"MT	57	60	½	42	40	45	960	5	pce
1070637	20-20-R¾"MT	61	62	¾	42	40	45	960	5	pce

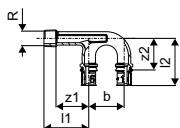

Uponor S-Press PLUS

Uponor S-Press PLUS tap elbow twin 90 long

- Unique press indicator
- Fast 3-step installation (press without bevel)
- Innovative QR code for immediate digital access
- For on wall installation or attachment with rotation protection to the Uponor Smart Aqua mounting angles and plates.
- Thread acc. to EN ISO 228-1



Item no.	Dimension	l1	l2	l3	l4	Rp	z1	z2	z3	k	k1	Qty 2	Qty 1	UOM
		mm	mm	mm	mm	inch	mm	mm	mm	mm	mm			
1070648	16-Rp½"FT-16	44	45	30	20	½	24	25	15	20	20	40	10	pce
1070649	20-Rp½"FT-20	46	46	30	20	½	24	25	15	20	20	40	10	pce

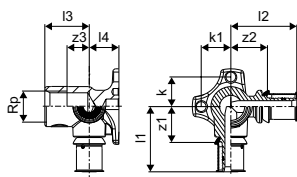

Uponor S-Press PLUS elbow adapter UPS

- Unique press indicator
- Fast 3-step installation (press without bevel)
- Innovative QR code for immediate digital access



Item no.	Dimension	l1	l2	Rp	M	z1	z2	Qty 2	Qty 1	UOM
		mm	mm	inch	mm	mm	mm			
1070657	16-Rp½"FT	29	48	½	35x1.5	8	28	10	1	pce

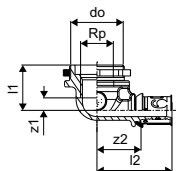

Uponor Smart Aqua adapter flushing tank Geberit

- Compression adapter, union nut and inner sleeve made of brass
- For connection of Uponor pipes to in wall flushing box Geberit and all MeplaFix R½ male threads



Item no.	Dimension	l	l1	l2	G	z1	Qty 2	Qty 1	UOM
		mm	mm	mm	inch	mm			
1058097	16-½"FT	22	14	8	½	1	25	1	pce

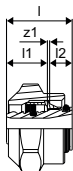

Uponor S-Press PLUS

Uponor S-Press PLUS stop end

- Unique press indicator
- Fast 3-step installation (press without bevel)
- Innovative QR code for immediate digital access

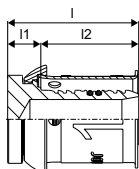

Item no.	Dimension	l mm	l1 mm	l2 mm	Qty 2	Qty 1	UOM
1070621	16	27	7	20	160	40	pce
1070622	20	28	7	21	7680	20	pce
1070623	25	35	7	28	3840	10	pce
1070624	32	35	7	28	1920	5	pce

Uponor MLC pressure testing plug

- Re-usable plug for pressure test of installations, screwed into bevelled pipe
- After completion of the pressure test unscrew the pressure test plug out of the pipe and cut it to the required length (length of plug + 1.5mm).

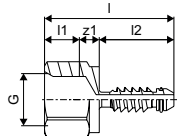

Item no.	Dimension	l mm	l1 mm	l2 mm	G mm	z1 mm	Qty 2	Qty 1	UOM
1013756	16	52	14	30	1/2	8	7680	20	pce
1013760	20	52	14	30	1/2	8	3840	20	pce
1013762	25	57	14	35	1/2	8	3840	10	pce
1013764	32	64	14	42	1/2	8	3840	10	pce
1013765	40	67	14	45	1/2	8	960	5	pce

Uponor S-Press valve U-shaped

- Made of brass
- Contoured Aluminium-sleeve
- Fast 3-step installation (press without bevel)
- Colour code
- For cold and hot tap water application

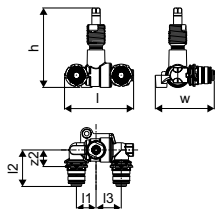

Item no.	Dimension	l mm	l1 mm	l2 mm	l3 mm	z2 mm	h mm	w mm	Qty 2	Qty 1	UOM
1089028	16	74	21	39	27	18	85	63	10	1	pce
1089027	20	76	21	40	27	18	86	63	10	1	pce
1089026	25	106	36	50	36	20	92	74	5	1	pce

Uponor S-Press PLUS

Uponor S-Press valve straight

- Made of brass
- Contoured Aluminium-sleeve
- Fast 3-step installation (press without bevel)
- Colour code
- For cold and hot water application



Item no.	Dimension	l1	l2	z1	z2	h	Qty 2	Qty 1	UOM
		mm	mm	mm	mm	mm			
1089031	16	37	44	16	23	71	10	1	pce
1089030	20	38	45	16	23	71	10	1	pce
1089029	25	48	54	18	24	73	10	1	pce

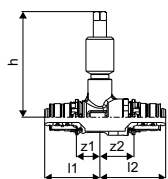

Uponor S-Press PLUS adapter wall penetr.

- Unique press indicator
- Fast 3-step installation (press without bevel)
- Innovative QR code for immediate digital access
- For lead-through through walls.
- Dimensions of attachment plate (H x W x D) 100 x 50 x 2 mm.
- Hole circle diameter 33 mm.



Item no.	Dimension	l	l1	l2	l3	s	Rp	z1	k	Qty 2	Qty 1	UOM
		mm	mm	mm	mm	mm	inch	mm	mm			
1070652	16-G $\frac{1}{2}$ "FT	51	17	20	100	2	$\frac{1}{2}$	14	40	5	1	pce

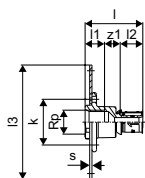

Uponor S-Press PLUS tap elbow LWC

- Unique press indicator
- Fast 3-step installation (press without bevel)
- Innovative QR code for immediate digital access
- Incl. twist-proof attachment and sound protection
- For lead-through through walls.



Item no.	Dimension	l1	l2	G	Rp	z1	z2	g	k	Qty 2	Qty 1	UOM
		mm	mm	inch	inch	mm	mm	mm	mm			
1070653	16-Rp $\frac{1}{2}$ "FT l=25	49	46	$\frac{3}{4}$	$\frac{1}{2}$	19	26	NaN	50	5	1	pce
1070654	16-Rp $\frac{1}{2}$ "FT l=35	59	46	$\frac{3}{4}$	$\frac{1}{2}$	19	26	NaN	50	5	1	pce

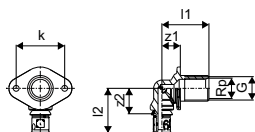

Uponor S-Press PLUS

Uponor S-Press PLUS U-tap elbow LWC

- Unique press indicator
- Fast 3-step installation (press without bevel)
- Innovative QR code for immediate digital access
- Incl. twist-proof attachment and sound protection
- For lead-through through walls.

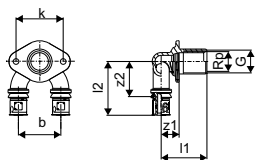

Item no.	Dimension	l1	l2	G	Rp	z1	z2	b	k	Qty 2	Qty 1	UOM
		mm	mm	inch	inch	mm	mm	mm	mm			
1070655	16-Rp½"FT-16 l=25	49	57	¾	½	19	37	45	50	5	1	pce
1070656	16-Rp½"FT-16 l=35	59	57	¾	½	19	37	45	50	5	1	pce

Uponor S-Press PLUS mounting plate

- Made of galvanized steel.
- For the installation of Uponor Smart Aqua tap elbows
- Positioning of the connections in the given raster
- Plastic pins and loss protected screws M6x12 acc. DIN 965 included
- With holes and slots for easy attachment

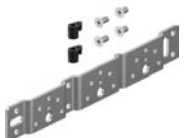

NEW

Item no.	Dimension	l	s	h	k	k1	w	Qty 2	Qty 1	UOM
		mm	mm	mm	mm	mm	mm			
1121197	80/150mm	265	3	9	80	150	35	5	1	pce

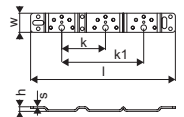

Uponor S-Press PLUS mounting angle

- Made of galvanized steel.
- For the installation of Uponor Smart Aqua tap elbows
- Positioning of the connections in the given raster
- Plastic pins and loss protected screws M6x12 acc. DIN 965 included
- With holes and slots for easy attachment

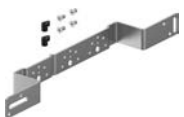

NEW

Item no.	Dimension	l	s	b	h	k	k1	w	Qty 2	Qty 1	UOM
		mm	mm	mm	mm	mm	mm	mm			
1121195	80/150mm	440	3	266	57	80	150	35	5	1	pce

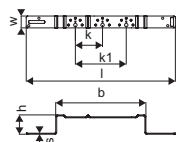

Uponor S-Press PLUS

Uponor Smart Aqua single mounting angle

- Made of galvanized steel.
- For the installation of Uponor Smart Aqua tap elbows.
- Positioning of the connections in the given raster.
- Screws M6x12 acc. DIN 965 included. With holes and slots for easy attachment



Item no.	Dimension	l mm	b mm	h mm	Qty 2	Qty 1	UOM
1057843		144	82	46	5	1	pce

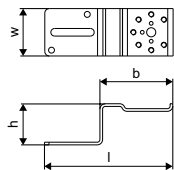

Uponor Smart Aqua mounting rack

- Made of galvanized steel.
- For the installation of Uponor Smart Aqua tap elbows.
- Positioning of the connections in the given raster.
- Screws M6x12 acc. DIN 965 included. With holes and slots for easy attachment

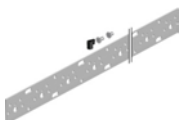

Item no.	Dimension	l mm	k mm	Qty 2	Qty 1	UOM
1057844	2m	2000	75	10	1	pce

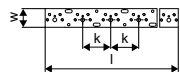

Uponor Smart Aqua mounting rack bending tool

- For bending the 2 meter long mounting track.



Item no.	Dimension	Qty 2	Qty 1	UOM
1015424	2m	100	1	pce

Uponor Smart Aqua 10 pins+20 screws

- Pins and screws for mounting plates, angles and tracks.



Item no.	Dimension	l mm	do1 mm	do2 mm	c/c1 mm	Qty 1	UOM
1057847*		17	4	10	10	1	set

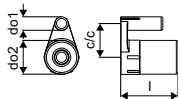

Uponor S-Press PLUS

Uponor S-Press PLUS adapter

- Unique press indicator
- Fast 3-step installation (press without bevel)
- Innovative QR code for immediate digital access
- With soldered copper pipe according EN 1057 (half hard / R250)
- complete tin-plated
- Attention:
The copper side is for press connections and suitable compression fittings only.

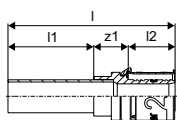

Item no.	Dimension	l	l1	l2	z1	Qty 2	Qty 1	UOM
		mm	mm	mm	mm			
1070615	16-15CU	76	40	20	16	160	20	pce
1070707	20-15CU	76	39	21	16	3840	10	pce
1070617	20-22CU	81	41	21	19	60	15	pce
1070618	25-22CU	88	41	28	19	20	5	pce
1070619	25-28CU	92	43	28	21	1920	5	pce
1070620	32-28CU	92	43	28	21	20	5	pce

Uponor S-Press PLUS radi crossing insulated

- Unique press indicator
- Fast 3-step installation (press without bevel)
- Innovative QR code for immediate digital access
- For cross-over-free connection of a radiator on the raw floor
- Incl. insulation box, consisting of upper and lower part made of EPP (expanded polypropylene) with 13 mm insulation layer (corresponds to 50 % insulation in compliance with EnEV), WLG 035. Meets EnEV requirements in respect of pipe cross-overs and wall penetrations!
- Dimensions of insulation box
(Length x Width x Height): 115 x 115 x 55 mm.

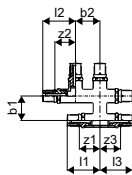

Item no.	Dimension	l1	l2	l3	s	z1	z2	z3	b1	b2	Qty 2	Qty 1	UOM
		mm	mm	mm	mm	mm	mm	mm	mm	mm			
1070689	16-16-16	54	54	54	40,0	34	34	34	40	40	192	1	pce
1070690	20-16-16	56	56	55	40,0	34	34	34	40	40	192	1	pce
1070691	20-16-20	56	55	55	40,0	34	34	34	40	40	192	1	pce
1070692	20-20-20	56	56	56	40,0	34	34	34	40	40	192	1	pce

Uponor Smart Radi connection unit box

- Made of polystyrene with removable protective cap (WLS 040)
- Insulation box, flame resistant, B1 acc. to DIN 4102
- 100% acc. EnEV in outer wall

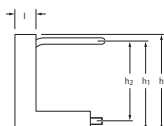

Item no.	Dimension	d	l	b	h	h1	h2	Qty 2	Qty 1	UOM
		mm	mm	mm	mm	mm	mm			
1013134	16 h=215mm	16	50	100	260	240	215	240	10	pce
1007077	16 h=240mm	16	50	100	285	265	240	240	10	pce

Uponor S-Press PLUS

Uponor S-Press PLUS radi elbow adapter plated

- With copper pipe 15 x 1 mm and 22 x 1 mm, plated.
- The connection of the plated copper pipe 15 x 1 mm to the radiator can be made with the Uponor clamp compression adapter Cu (Item-No. 1013830).



Item no.	Dimension	l1 mm	l2 mm	z1 mm	Qty 2	Qty 1	UOM
1070678	16-15CU l=350mm	366	37	17	1680	20	pce
1070679	16-15CU l=1000mm	1116	37	17	400	20	pce

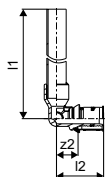

Uponor S-Press PLUS radi tee adapter plated

- With cranked copper pipe 15 x 1 mm, plated
- The connection of the plated copper pipe 15 x 1 mm to the radiator can be made with the Uponor clamp compression adapter Cu (Item-No. 1013830).



Item no.	Dimension	l1 mm	l2 mm	l3 mm	z1 mm	z3 mm	b mm	Qty 2	Qty 1	UOM
1070681	16-15CU-16 l=350mm	38	351	38	18	18	26	600	20	pce
1070682	20-15CU-20 l=350mm	40	353	40	19	19	27	600	20	pce

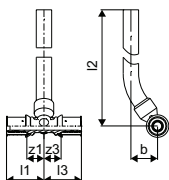

Uponor Smart Radi adapter plated

- Made of coated copper pipe
- copper pipe 15 x 1 mm with self sealing thread for the connection to radiator
- Fits to all Uponor press tap elbow MLC, press tap wall plate MLC and press female connection 1/2" MLC
- Connection to the radiator with the Uponor eurocone compression adapter Cu.



Item no.	Dimension	l mm	G inch	z1 mm	Qty 2	Qty 1	UOM
1015425	G1/2"MT-15CU l=350mm	369	1/2	356	640	20	pce

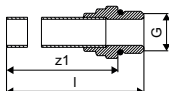

Uponor S-Press PLUS

Uponor Smart Radi adapter

- With 3/4FT eurocone, elastically sealing, for the connection of the coated copper pipe 15 x 1 mm of the Uponor press connection elbow, Uponor press connection tee to the tap battery, radiator or Uponor radiator connection adapter with 3/4FT eurocone.
- Coated brass union nut, brass clamp ring blank and sealing cone made of EPDM.
- Ribbed union nut with wrench size 27.

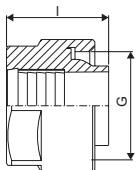

Item no.	Dimension	l mm	Qty 2	Qty 1	UOM
1013830	15CU-3/4" Euro	21	80	10	pce

Uponor Smart Radi adapter sealed

- Made of coated brass
- self-sealing
- For the connection of radiators with 1/2 female thread connectors, 3/4 male thread eurocone for the connection of Cu-pipe, 15 x 1 mm, with clamp compression adapter.

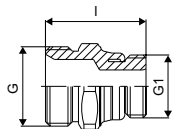

Item no.	Dimension	l mm	G inch	G1 inch	Qty 2	Qty 1	UOM
1013906	G3/4"MT-G1/2"MT	34	3/4	1/2	80	10	pce

Uponor Smart Radi compr. connection set Danfoss

- Made of coated brass
- pressure screw with male thread, with inner sleeve and clamp ring, fit to Danfoss radiator valves with female thread
- O-Ring, blue, made of EPDM.

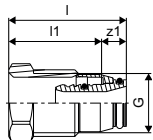

Item no.	Dimension	l mm	l1 mm	G inch	z1 mm	Qty 2	Qty 1	UOM
1013970	16-G1/2"MT	37	29	1/2	8	20	1	pce

Uponor S-Press PLUS

Uponor Smart Radi compr. connection set Heimeier

- Made of coated brass
- pressure screw with male thread, with inner sleeve and clamp ring, fit to Heimeier radiator valves with female thread
- O-Ring, grey, made of EPDM.



Item no.	Dimension	l	l1	G	z1	Qty 2	Qty 1	UOM
		mm	mm	inch	mm			
1013978	16-G½"MT	34	28	½	6	20	1	pce

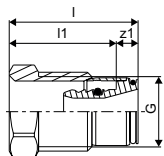

Uponor Smart Radi cover plate dividable

- Made of polypropylene, white
- for Uponor Uni Pipe PLUS and MLC pipes
- Required distance (pipe middle - middle) between two snap rings, e.g. for supply and return of the heating line approx. 50 mm.
- Fire classification E acc. to EN 13501-1.



Item no.	Dimension	Qty 2	Qty 1	UOM
1011370	16 white	20000	50	pce
1011372	20 white	16000	50	pce

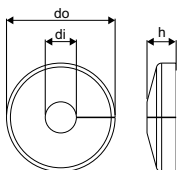

Uponor Smart Radi cover plate dividable

- Made of polypropylene white
- for Uponor Uni Pipe PLUS and MLC pipes 14 - 20 mm, to cover floor and/or wall penetration of the radiator connection pipe line
- Required inside micrometer (pipe middle - middle) between two Uponor MLC pipes for supply and return flow: 50 mm. The cascaded penetrations can be severed easily with a knife according to desired pipe dimension.
- The snap ring consists of two halves, which are pressed together with two push buttons by hand
- Fire classification B2 acc. to EN 13501-1.



Item no.	Dimension	Qty 2	Qty 1	UOM
1011373	14-20 white double	500	50	pce

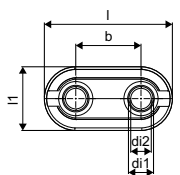

Uponor RS

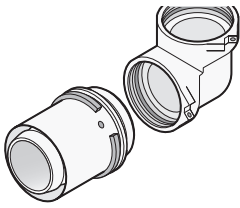

adaptable.

Uponor RS is a unique system that follows a modular design principle for riser systems and other distribution lines. Just 40 system components enable hundreds of variations, making the system highly

Your benefits

- Innovative plug connection between body and adapter
- Fast and flexible: tool-free assembly, many variations
- More efficient stock management
- Re-adjustment possible until final installation
- Colour coding 16 -110mm for easy dimension selection



Specification

- with fixed press sleeve
- stop ring
- colour code
- Test safety

Application

- Tap water: The permanent operating temperature ranges from 0°C to 70°C at a maximum permanent operating pressure of 10 bar. The short-term malfunction temperature is 95°C for a period of 100 hours in the operating life time.
- Heating: The permanent operating temperature ranges up to 80°C at a maximum permanent operating pressure of 10 bar. The short-term malfunction temperature is 100°C for a period of 100 hours in the operating life time.

if not different mentioned:

- Male and female threads acc.to EN 10226-1.

Certification

- Approvals by local OM.

E.g.

- DVGW
- AENOR

Uponor RS coupling

- Made of tin-plated brass
- Base part for all RS2 or RS3 inserts including 2 lock pins.



Item no.	Dimension	l mm	Qty 2	Qty 1	UOM
1029144	RS2-RS2	58	480	1	pce
1029145	RS3-RS3	58	480	1	pce

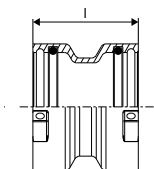

Uponor RS

Uponor RS elbow

- Made of tin-plated brass
- Base part for all RS2 or RS3 inserts including 2 lock pins.

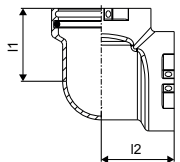

Item no.	Dimension	I1 mm	I2 mm	Qty 2	Qty 1	UOM
1029138	RS2-RS2	51	51	336	1	pce
1029139	RS3-RS3	68	68	240	1	pce

Uponor RS elbow 45

- Made of tin-plated brass
- Base part for all RS2 or RS3 inserts including 2 lock pins.

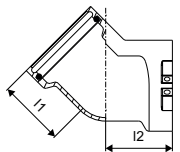

Item no.	Dimension	I1 mm	I2 mm	Qty 2	Qty 1	UOM
1029140	RS2-RS2	51	51	336	1	pce
1029141	RS3-RS3	68	68	175	1	pce

Uponor RS tee

- Made of tin-plated brass
- Base part for all RS2 or RS3 inserts including 3 lock pins.

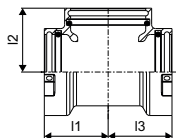

Item no.	Dimension	I1 mm	I2 mm	I3 mm	Qty 2	Qty 1	UOM
1029142	RS2-RS2-RS2	51	51	51	336	1	pce
1029143	RS3-RS3-RS3	68	68	68	175	1	pce

Uponor RS

Uponor RS reducer

- Made of tin-plated brass
- Reducer from RS3 to RS2 including 1 lock pin.

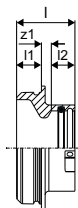

Item no.	Dimension	l mm	l1 mm	l2 mm	z1 mm	Qty 2	Qty 1	UOM
1029146	RS3-RS2	47	20	19	8	480	1	pce

Uponor RS spacer

- Made of tin plated-brass
- Spacer to connect RS base parts of equal dimensions.

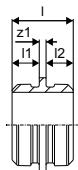

Item no.	Dimension	l mm	l1 mm	l2 mm	z1 mm	Qty 2	Qty 1	UOM
1046750	RS2-RS2 l=5mm	45	20	20	5	480	1	pce
1046751*	RS3-RS3 l=5mm	45	20	20	5	240	1	pce

Uponor RS spacer

- Made of tin-plated brass
- Spacer to connect RS base parts of equal dimensions e.g to create T-manifold or shift in distribution lines.

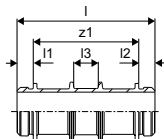

Item no.	Dimension	l mm	l1 mm	l2 mm	l3 mm	z1 mm	Qty 2	Qty 1	UOM
1046477*	RS2-RS2 l=130mm	170	20	20	30	130	240	1	pce
1046478*	RS3-RS3 l=210mm	250	20	20	30	210	96	1	pce

Uponor RS

Uponor RS adapter S-Press

- Made of tin-plated brass
- Fits to all RS2 base parts.

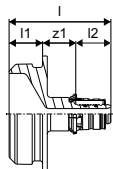

Item no.	Dimension	l mm	l1 mm	l2 mm	z1 mm	Qty 2	Qty 1	UOM
1059397	16-RS2	61	20	21	20	480	1	pce

Uponor RS adapter S-Press PLUS

- tin plated
- made of DR material
- press without bevel

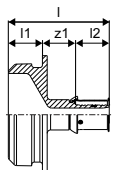

Item no.	Dimension	l mm	l1 mm	l2 mm	z1 mm	Qty 2	Qty 1	UOM
1095818	20-RS2	61	20	21	20	378	1	pce
1095819	25-RS2	75	20	28	27	378	1	pce
1095820	32-RS2	75	20	28	27	378	1	pce

Uponor RS adapter S-Press

- Made of tin-plated brass
- Fits to all RS2 or RS3 base parts.

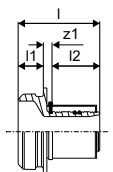

Item no.	Dimension	l mm	l1 mm	l2 mm	z1 mm	Qty 2	Qty 1	UOM
1046940	40-RS2	65	20	38	7	480	1	pce
1046941	50-RS2	65	20	38	7	480	1	pce
1029125	63-RS2	88	20	61	7	400	1	pce
1029126	75-RS2	88	20	61	7	400	1	pce
1029127	90-RS3	93	20	62	11	240	1	pce
1029128	110-RS3	93	20	62	11	240	1	pce

Uponor RS

Uponor RS adapter male thread

- Made of tin-plated brass
- Fits to all RS2 or RS3 base parts

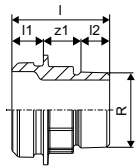

Item no.	Dimension	l mm	l1 mm	l2 mm	R inch	z1 mm	Qty 2	Qty 1	UOM
1059402	R1 ½"MT-RS2	62	20	24	1 ½	18	480	1	pce
1029131	R2"MT-RS2	66	20	23	2	23	480	1	pce
1029132	R2 ½"MT-RS2	63	20	27	2 ½	16	480	1	pce
1029133	R3"MT-RS3	73	20	30	3	23	240	1	pce

Uponor RS adapter female thread

- Made of tin-plated brass.
- fits to all RS2 or RS3 base parts

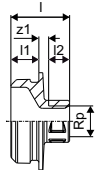

Item no.	Dimension	l mm	l1 mm	l2 mm	Rp mm	z1 mm	Qty 2	Qty 1	UOM
1059403	Rp½"FT-RS2	42	20	15	½	7	480	1	pce
1029134	Rp1"FT-RS2	45	20	19	1	6	480	1	pce
1029135	Rp2"FT-RS2	54	20	26	2	8	480	1	pce
1029136	Rp2 ½"FT-RS2	63	20	30	2 ½	12	480	1	pce
1059404	Rp½"FT-RS3	43	20	15	½	8	336	1	pce
1029137	Rp3"FT-RS3	65	20	33	3	12	240	1	pce

Uponor RS flange adapter

- Made of tin-plated brass
- Fits to all RS2 or RS3 base parts
- Flange PN6/PN16 acc. to EN 1092-3
- Bolt circle with 4/8 holes.

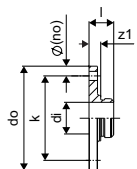

Item no.	Dimension	l mm	di mm	do mm	z1 mm	k mm	p bar	Qty 2	Qty 1	UOM
1059398	RS2-DN65 (PN6)	38	48,7	160	18	130	6	144	1	pce
1059399*	RS2-DN65 (PN16)	45	48,7	185	25	145	16	90	1	pce
1059400	RS3-DN80 (PN6)	38	78,1	190	18	150	6	90	1	pce
1029129*	RS3-DN80 (PN16)	45	78,1	200	25	160	16	90	1	pce
1059401	RS3-DN100 (PN6)	41	78,1	210	21	170	6	90	1	pce
1029130	RS3-DN100 (PN16)	44	78,1	220	24	180	16	90	1	pce

Uponor RS

Uponor RS lock pin

- made of plastic
- to lock the RS insert to the RS base part.



Item no.	Dimension	colour	Qty 2	Qty 1	UOM
1042921	RS2 black	black	5000	10	pce
1042922	RS3 grey	grey		10	pce

Uponor RTM

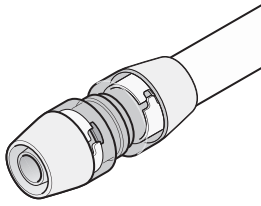

Uponor RTM fittings are designed to be tool independent and work with selected Uponor pipes to create perfect pipe connections. They are quick to use, secure, and result in a long-lasting, leak-free joint.

RTM fittings work perfectly for tap water and heating/cooling application.

Your benefits

- Consistent pressure around pipe
- Colour coded joint indicator
- No tool dependence
- Joint indicator: visible and audible
- Fast and easy installation



Specification

- tool inside concept
- pressed identification
- colour code

Application

- Tap water: The permanent operating temperature ranges from 0°C to 70°C at a maximum permanent operating pressure of 10 bar. The short-term malfunction temperature is 95°C for a period of 100 hours in the operating life time.
- Heating: The permanent operating temperature ranges up to 80°C at a maximum permanent operating pressure of 10 bar. The short-term malfunction temperature is 100°C for a period of 100 hours in the operating life time.

Certification

- Approvals by local OM.
- E.g.
- DVGW
- AENOR

Uponor Flex con. valve, long handle

- Chrome plated lever and cover rosette.
- For Concealed valves.

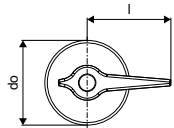

Item no.	Dimension	l	do	Qty 2	Qty 1	UOM
		mm	mm			
1023161		67	67,8	10	10	pce

Uponor RTM

Uponor Flex con valve, public handle

- Chrome plated lever and cover rosette.
- For Concealed valves.

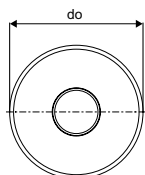

Item no.	Dimension	do mm	Qty 2	Qty 1	UOM
1023162		67,8	10	1	pce

Uponor Flex con valve, wheel handle

- For Concealed valves.



Item no.	Dimension	Qty 2	Qty 1	UOM
1038462		10	1	pce

Uponor Flex con valve handle extension

- For Concealed valves.



Item no.	Dimension	Qty 2	Qty 1	UOM
1023163		520	10	pce

Uponor S-Press PLUS mounting plate

- Made of galvanized steel.
- For the installation of Uponor Smart Aqua tap elbows
- Positioning of the connections in the given raster
- Plastic pins and loss protected screws M6x12 acc. DIN 965 included
- With holes and slots for easy attachment

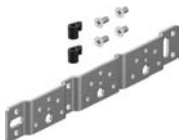

NEW

Item no.	Dimension	l mm	s mm	h mm	k mm	k1 mm	w mm	Qty 2	Qty 1	UOM
1121197	80/150mm	265	3	9	80	150	35	5	1	pce

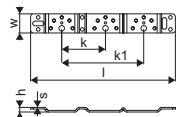

Uponor RTM

Uponor S-Press PLUS mounting angle

- Made of galvanized steel.
- For the installation of Uponor Smart Aqua tap elbows
- Positioning of the connections in the given raster
- Plastic pins and loss protected screws M6x12 acc. DIN 965 included
- With holes and slots for easy attachment

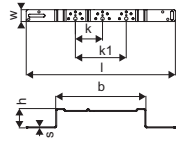
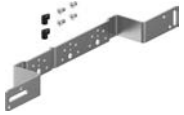

NEW

Item no.	Dimension	l mm	s mm	b mm	h mm	k mm	k1 mm	w mm	Qty 2	Qty 1	UOM
1121195	80/150mm	440	3	266	57	80	150	35	5	1	pce

Uponor Uni-X

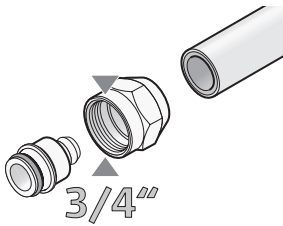

Uponor Uni-X is a compression fittings range of 3/4" eurocone connectors, metrical conus and adaptors for tap water and heating/cooling application.

Your benefits

- Simple adaption to other pipes and systems
- Flexible system design
- No special tools required



Application

- For the distribution of heating water for the radiator connection

Uponor Uni-X compression adapter MLC

- Compression adapter, union nut and inner sleeve
- made of brass
- For connection of Uponor Uni Pipe PLUS and MLC pipes to manifolds (eg. Uponor manifold H).
- Female thread 3/4" eurocone according to EN ISO 228-1

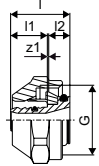

Item no.	Dimension	l	l1	G	z1	Qty 2	Qty 1	UOM
		mm	mm	inch	mm			
1058089	14-3/4"FT Euro	23	13	3/4	3	25	1	pce
1058090	16-3/4"FT Euro	23	13	3/4	3	25	1	pce
1058092	20-3/4"FT Euro	24	14	3/4	3	25	1	pce
1058093	25-3/4"FT Euro	27	14	3/4	7	25	1	pce

Uponor Uni-X compr. coupling, renovation

- Connection set for Uponor Uni Pipe PLUS or MLC pipes to third party pipes for renovation purpose
- Compression adapter made of brass, 3/4 Uponor euro cone coupling nipple and compression adapter MLC tin-plated brass
- Note: Only for renovation.

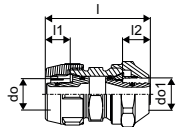

Item no.	Dimension	l	l1	l2	do	do1	Qty 2	Qty 1	UOM
		mm	mm	mm	mm	mm			
1048745	16x2,0-16x2,0	53	14	14	16	16	10	1	set
1048746	16x2,0-16x2,25	53	14	14	16	16	10	1	set
1048747	20x2,25-20x2,25	53	14	14	20	20	10	1	set
1048748	20x2,25-20x2,5	53	14	14	20	20	10	1	set

Uponor Uni-X

Uponor Uni-X compression adapter MLC

- Compression adapter, union nut and inner sleeve made of brass
- For connection of Uponor Uni Pipe PLUS and MLC pipes to radiator valves similar to Comap and Herz with M² threads.
- No bevel.



Item no.	Dimension	l mm	l1 mm	l2 mm	M mm	z1 mm	Qty 2	Qty 1	UOM
1058094	16-M ²	23	13		22	4	25	1	pce

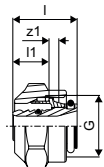

Uponor Uni-X compression adapter MLC

- Compression adapter, union nut and inner sleeve made of brass
- For connection of Uponor MLC pipes to radiator valves similar to Oventrop and Heimeier with M²4x1,5 threads
- No bevel.



Item no.	Dimension	l mm	l1 mm	M mm	z1 mm	Qty 2	Qty 1	UOM
1058095	16-M ² 4	23	13	24	4	25	1	pce

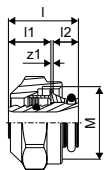

Uponor Uni-X coupling male thread

- Made of tin-plated brass
- Female thread acc.to EN 10226-1
- Male thread acc. to EN ISO 228-1.



Item no.	Dimension	l mm	G inch	G1 inch	z1 mm	Qty 2	Qty 1	UOM
1014143	¾"MT-¾"FT Euro	31	¾	¾	8	80	10	pce

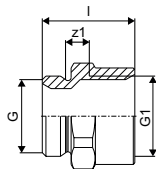

Uponor Uni-X

Uponor Uni-X coupling plated

- Made of tin-plated brass
- Male thread acc. to EN ISO 228-1.

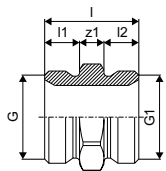

Item no.	Dimension	l mm	l1 mm	l2 mm	G inch	G1 inch	z1 mm	Qty 2	Qty 1	UOM
1006641	G $\frac{3}{4}$ "MT Euro-G $\frac{3}{4}$ "MT Euro	27	10	10	$\frac{3}{4}$	$\frac{3}{4}$	7	80	20	pce

Uponor Uni-X elbow male thread

- Made of tin-plated brass
- Male thread acc. to EN ISO 228-1.

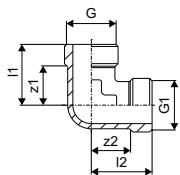

Item no.	Dimension	l1 mm	l2 mm	G inch	G1 inch	z1 mm	z2 mm	Qty 2	Qty 1	UOM
1014145	$\frac{3}{4}$ "MT- $\frac{3}{4}$ "MT Euro	30	30	$\frac{3}{4}$	$\frac{3}{4}$	19	19	80	10	pce

Uponor Uni-X tee male thread

- Made of tin-plated brass
- Male thread acc. to EN ISO 228-1.

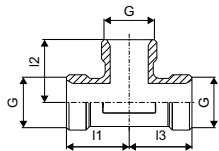

Item no.	Dimension	l1 mm	l2 mm	l3 mm	G inch	G1 inch	G2 inch	Qty 2	Qty 1	UOM
1014147	$\frac{3}{4}$ "MT- $\frac{3}{4}$ "MT- $\frac{3}{4}$ "MT	30	30	30	$\frac{3}{4}$	$\frac{3}{4}$	$\frac{3}{4}$	40	10	pce

Uponor Uni-X

Uponor Uni-X manifold H 1"SN

- Manifold made of stainless steel
- Flat-sealing connection 1" female thread including flat seal

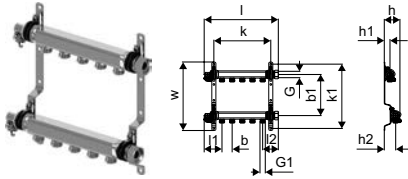

Item no.	Dimension	outlets	l mm	l1 mm	l2 mm	G inch	G1 inch	b mm	b1 mm	b2 mm	h mm	h1 mm	h2 mm	k mm	k1 mm	w mm	p bar	Qty 2	Qty 1	UOM
12.22	1088873 2xG $\frac{3}{4}$ Euro	2	210	87	73	1	$\frac{3}{4}$	50	215	215	75	30	50	135	336	357	6	108	1	pce
12.22	1088874 3xG $\frac{3}{4}$ Euro	3	260	87	73	1	$\frac{3}{4}$	50	215	215	75	30	50	185	336	357	6	108	1	pce
12.22	1088875 4xG $\frac{3}{4}$ Euro	4	310	87	73	1	$\frac{3}{4}$	50	215	215	75	30	50	235	336	357	6	108	1	pce
12.22	1088876 5xG $\frac{3}{4}$ Euro	5	360	87	73	1	$\frac{3}{4}$	50	215	215	75	30	50	285	336	357	6	108	1	pce
12.22	1088877 6xG $\frac{3}{4}$ Euro	6	410	87	73	1	$\frac{3}{4}$	50	215	215	75	30	50	335	336	357	6	72	1	pce
12.22	1088878 7xG $\frac{3}{4}$ Euro	7	460	87	73	1	$\frac{3}{4}$	50	215	215	75	30	50	385	336	357	6	72	1	pce
12.22	1088879 8xG $\frac{3}{4}$ Euro	8	510	87	73	1	$\frac{3}{4}$	50	215	215	75	30	50	435	336	357	6	72	1	pce
12.22	1088880 9xG $\frac{3}{4}$ Euro	9	560	87	73	1	$\frac{3}{4}$	50	215	215	75	30	50	485	336	357	6	72	1	pce
12.22	1088881 10xG $\frac{3}{4}$ Euro	10	610	87	73	1	$\frac{3}{4}$	50	215	215	75	30	50	535	336	357	6	48	1	pce
12.22	1088882 11xG $\frac{3}{4}$ Euro	11	660	87	73	1	$\frac{3}{4}$	50	215	215	75	30	50	585	336	357	6	48	1	pce
12.22	1088883 12xG $\frac{3}{4}$ EURO	12	710	87	73	1	$\frac{3}{4}$	50	215	215	75	30	50	635	336	357	6	48	1	pce

Uponor Vario ball valve

- Made of brass, nickel-plated

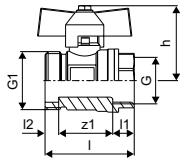

Item no.	Dimension	l mm	l1 mm	l2 mm	l3 mm	G inch	G1 inch	z1 mm	Qty 2	Qty 1	UOM
1086558	$\frac{3}{4}$ -G1	51	12	8	43	$\frac{3}{4}$	1	31	10	1	set

Uponor Vario ball valve

- Made of brass nickel-plated
- For flat sealing vertical connection G1
- 60 mm + length of the manifold



Item no.	Dimension	AG inch	IG inch	Qty 2	Qty 1	UOM
1059132	NP G1-G1	1	1	10	1	set

Uponor Uni-X

Uponor Vario ball valve elbow

- Made of brass, nickel-plated



Item no.	Dimension	l1	l2	l3	do	G	Rp	z1	z2	z3	h	w	Qty	UOM
		mm	mm	mm	mm	inch	inch	mm	mm	mm	mm	mm	1	set
1086559	Rp 3/4" - G1"	31	95	94	33	1	3/4	22	88	27	43	60		

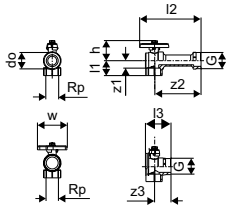

Uponor Uni-C

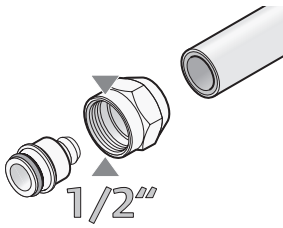

Uponor Uni-C 1/2" threaded compression manifolds made of tin-plated brass is a range of fittings and adaptors designed for tap water and heating/cooling application.

Your benefits

- Easily adaptable to other systems
- Installation flexibility
- No special tools required



Uponor Uni-C manifold male female thread S

- Made of tin-plated brass
- with connection 1" for male thread or female thread, outlets 1/2" male thread fits to Uponor compression adapter.

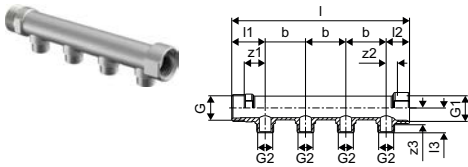

Item no.	Dimension	outlets	l	l1	l2	l3	G	G1	G2	z1	z2	z3	b	Qty 2	Qty 1	UOM
			mm	mm	mm	mm	inch	inch	inch	mm	mm	mm	mm			
1014107*	1"MT/FT 2X1/2"MT	2	121	42	29	31	1	1	1/2	26	14	21	50	1218	1	pce
1014111*	1"MT/FT 3X1/2"MT	3	171	42	29	31	1	1	1/2	26	14	21	50	854	1	pce
1014109*	1"MT/FT 4X1/2"MT	4	220	42	29	31	1	1	1/2	26	14	21	50	679	1	pce

Uponor Uni-C male female, valve SH

- Made of tin-plated brass.
- With connection 1" for male thread or female thread
- outlets 1/2" male thread and valves to close each outlet separate.
- Corresponding compression adapters for connecting the Uponor MLC pipes from the basic assortment.

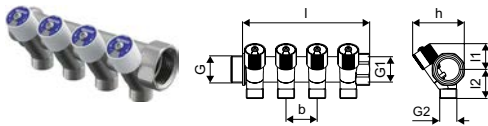

Item no.	Dimension	outlets	l	l1	l2	G	G1	G2	b	h	Qty 2	Qty 1	UOM
			mm	mm	mm	inch	inch	inch	mm	mm			
1014137	1"MT/FT 2X1/2"MT c/c38mm	2	79	31	36	1	1	1/2	38	63	30	6	pce
1014138	1"MT/FT 3X1/2"MT c/c38mm	3	117	31	36	1	1	1/2	38	63	20	4	pce
1014139	1"MT/FT 4X1/2"MT c/c38mm	4	155	31	36	1	1	1/2	38	63	15	3	pce

Uponor Uni-C manifold bracket S

- Supplied as a single bracket
- Made of galvanised steel, for the sound absorbing installation of Uponor Uni-C manifold male female thread S.



Item no.	Dimension	l	a	a1	Qty 2	Qty 1	UOM
		mm	mm	mm			
1014117		47	210	36	25	1	pce

Uponor Uni-C

Uponor Uni-C bracket SH

- Manifolds and accessories



Item no.	Dimension	Qty 2	Qty 1	UOM
1045451	¾" 1"	25	1	set

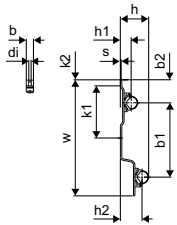

Uponor Uni-C manifold end plug male S/SH PL

- Made of plated brass
- for manifold S/SH.



Item no.	Dimension	l	G	z1	Qty 2	Qty 1	UOM
		mm	inch	mm			
1014123	1"MT	16	1	7	100	20	pce

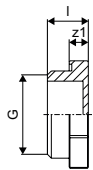

Uponor Uni-C end plug O-ring

- Made of plated brass
- with sealing O-Ring.



Item no.	Dimension	l1	z	Qty 2	Qty 1	UOM
		mm	mm			
1002274	1"MT	16	9	20	10	pce

Uponor Uni-C

Uponor Uni-C manifold end cap female S/SH PL

- Made of plated brass
- including seal for the manifold S/SH.

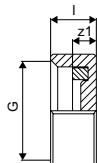

Item no.	Dimension	l mm	G inch	z1 mm	Qty 2	Qty 1	UOM
1014120	G½"FT	10	½	5	80	20	pce
1014121*	G1"FT	12	1	4	120	20	pce

Uponor Uni-C compression adapter MLC

- Compression adapter, union nut and inner sleeve made of brass
- For connection of Uponor Uni Pipe PLUS and MLC pipes to manifolds (e.g. Uponor manifold S, SH)
- Female thread ½" according to EN ISO 228-1
- No bevel.

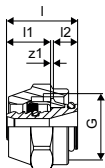

Item no.	Dimension	l mm	l1 mm	G inch	z1 mm	Qty 2	Qty 1	UOM
1058086	16-½"FT	23	13	½	4	25	1	pce
1058088	20-½"FT	26	14	½	7	25	1	pce

Uponor Uni-C coupling plated MLC

- Made of tin-plated brass
- Male thread acc.to DIN EN ISO 228-1

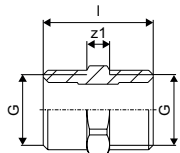

Item no.	Dimension	l mm	G inch	G1 inch	z1 mm	Qty 2	Qty 1	UOM
1013894	½"MT-½"MT	29	½	½	6	160	40	pce

Uponor Uni-C

Uponor Uni-C elbow plated MLC

- Made of tin-plated brass
- Male thread acc.to DIN EN ISO 228-1

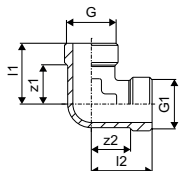

Item no.	Dimension	l1	l2	G	G1	z1	z2	Qty 2	Qty 1	UOM
		mm	mm	inch	inch	mm	mm			
1013914	G½"MT-G½"MT	29	29	½	½	18	18	80	20	pce

Uponor Uni-C elbow adapter plated MLC

- Made of tin-plated brass
- Male thread acc.to DIN EN ISO 228-1
- Female thread acc.to DIN EN 10226-1.

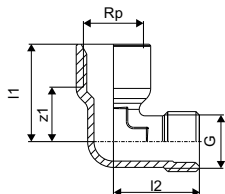

Item no.	Dimension	l1	l2	G	Rp	z1	Qty 2	Qty 1	UOM
		mm	mm	inch	inch	mm			
1013932	G½"MT-Rp½"FT	34	30	½	½	19	80	10	pce

Uponor Smart Aqua tap elbow Uni-C

- Made of tin-plated brass
- For on wall installation or attachment with rotation protection to the MLCP mounting angles and plate
- Male thread acc. to DIN EN ISO 228-1.

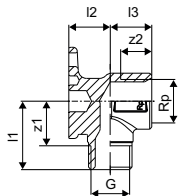

Item no.	Dimension	l1	l2	l3	Rp	R	z1	z2	Qty 2	Qty 1	UOM
		mm	mm	mm	inch	inch	mm	mm			
1015559	½"MT-½"FT	33	20	20	½	½	22	5	40	10	pce

uponor

Uponor GmbH

P.O. Box 1641
97433 Hassfurt
Germany

T +49-(0)9521 690 0
F +49-(0)9521 690 750
E international@uponor.com

03/2022



www.uponor.com