



**Radiant heating & cooling,  
plumbing and  
local heat distribution**

**Uponor**

**Product Catalogue 03-2022  
Local Heat Distribution  
(Ecoflex)**



# Uponor Ecoflex VIP Thermo

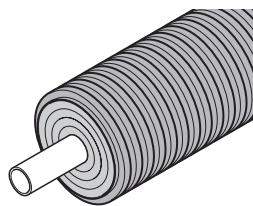

Uponor Ecoflex VIP Thermo pipes, produced based on European Standard EN 15632, are for heating and cooling applications. Single pipes are for projects with large flow requirements.

Thermo Twin offers supply

and return pipes in one jacket. The pipes have extremely good insulation performance and flexibility.

## Your benefits

- Excellent flexibility
- Revolutionary energy efficiency
- Proven performance of insulation material
- Pipe can be ordered in specified lengths
- Full range of fittings and accessories



## Specification

- Flexible, pre-insulated, self-compensating plastic pipe system produced based on EN 15632
- Medium pipe: cross-linked polyethylene (PE-Xa) pipe based on EN ISO 15875, natural colored, PN 6 (SDR 11), Oxygen tightness based on EN 15632
- Insulating material: Revolutionary insulation material with extremely low lambda value in combination with permanently elastic closed-cell PE-X foam
- Casing pipe: Corrugated polyethylene (HDPE)

## Application

- Transport of heating and cooling water for buried installations.
- Heating operating temperature 80°C based on EN 15632
- Malfunction temperature 95°C
- Static verification for heavy traffic load of 60 tons

## Certification

- Approvals should be checked by local responsible person

## Uponor Ecoflex VIP Thermo Single

- Heating and Cooling
- One medium pipe PE-Xa with oxygen barrier, SDR 11
- Max. load 6 bar / 95°C
- VIP + PEX foam, HDPE casing

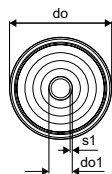

Item no.	Dimension	do mm	do1 mm	s mm	s1 mm	R m	Weight kg	Qty 1	UOM
1095714	40X3,7/140	140	40	3,7	0,35	1,67		200	m
1095715	50X4,6/140	140	50	4,6	0,4	1,93		200	m
1095716	63X5,8/140	140	63	5,8	0,5	2,35		200	m
1095717	75X6,8/140	140	75	6,8	0,6	2,73		200	m
1095718	90X8,2/175	175	90	8,2	0,7	4,00		150	m
1095719	110X10,0/175	175	110	10	0,9	5,08		150	m
1095720	125X11,4/200	200	125	11,4	1,4	6,65		120	m

# Uponor Ecoflex VIP Thermo

## Uponor Ecoflex VIP Thermo Twin

- Heating and Cooling
- Two medium pipes PE-Xa with oxygen barrier, SDR11
- Max. Load 6 bar / 95°C

Coloured centre profil to avoid confusion of flow and return line

VIP+PEX foam, HDPE casing

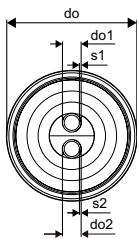

Item no.	Dimension	do mm	do1 mm	do2 mm	s1 mm	s2 mm	R m	Weight kg	Qty 1	UOM
<b>1118580</b>	2x25x2,3/140	140	25	25	2,3	2,3	0,4	1,70	200	m
<b>1118581</b>	2x32x2,9/140	140	32	32	2,9	2,9	0,5	1,91	200	m
<b>1118582</b>	2x40x3,7 /175	175	40	40	3,7	3,7	0,8	2,90	200	m
<b>1118583</b>	2x50x4,6/175	175	50	50	4,6	4,6	0,9	3,44	200	m
<b>1118584</b>	2x63x5,8/200	200	63	63	5,8	5,8	1,2	4,88	100	m
<b>1118585</b>	2x75x6,8/250	250	75	75	6,8	6,8	1,4	6,77	100	m

# Uponor Ecoflex Thermo

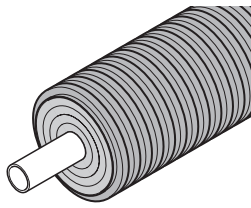

Uponor Ecoflex Thermo pipes, certified based on European Standard EN 15632, are for heating and cooling applications. Single pipes are for projects with large flow requirements.

Thermo Twin offers supply

and return pipes in one jacket. The pipes have long coil lengths and high flexibility for good installation and energy efficiency.

## Your benefits

- Excellent flexibility
- Good energy efficiency
- Reliable: 30 years of proven performance
- Can be ordered in specified lengths
- Full range of fittings and accessories
- Certified system



## Specification

- Flexible, pre-insulated, self-compensating plastic pipe system produced based on EN 15632
- Medium pipe: cross-linked polyethylene (PE-Xa) pipe based on EN ISO 15875, natural coloured, PN 6 (SDR 11) or PN 10 (SDR 7,4), Oxygen tightness based on EN 15632
- Insulating material: closed-cell PE-X foam, permanently elastic, ageing-resistant
- Casing pipe: Corrugated polyethylene (HDPE)

## Application

- Transport of heating and cooling water for buried installations.
- Heating operating temperature 80°C based on EN 15632
- Malfunction temperature 95°C
- Static verification for heavy traffic load of 60 tons

## Certification

- Approvals should be checked by local responsible person

## Uponor Ecoflex Thermo Single

- Heating and Cooling
- One medium pipe PE-Xa with oxygen barrier, SDR 11
- Max. load 6 bar / 95°C
- PEX foam, HDPE casing

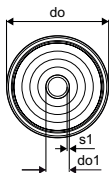

Item no.	Dimension	do mm	do1 mm	s1 mm	R m	R m	Weight kg	Qty 1	UOM
1018109	25x2,3/140	140	25	2,3	0,25	0,25	1,18	200	m
1018110	32x2,9/140	140	32	2,9	0,30	0,3	1,31	200	m
1018111	40x3,7/175	175	40	3,7	0,35	0,35	2,20	200	m
1018112	50x4,6/175	175	50	4,6	0,45	0,45	2,40	200	m
1018113	63x5,8/175	175	63	5,8	0,55	0,55	2,80	200	m
1018114	75x6,8/200	200	75	6,8	0,80	0,8	3,74	100	m
1018115	90x8,2/200	200	90	8,2	1,10	1,1	4,20	100	m
1018116	110x10,0/200	200	110	10	1,20	1,2	5,24	100	m

# Uponor Ecoflex Thermo

## Uponor Ecoflex Thermo Single PN10

- Heating and Cooling
- One medium pipe PE-Xa with oxygen barrier, SDR 7,4
- Max. load 10 bar / 95°C
- PEX foam, HDPE casing
- Production in Russia / Make to order / Please ask about delivery time

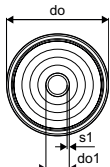

Item no.	Dimension	do mm	do1 mm	s1 mm	R m	R m	Weight kg	Qty 1	UOM
<b>1045877</b>	40x5,5/175	175	40	5,5	0,45		2,40	200	m
<b>1045878</b>	50x6,9/175	175	50	6,9	0,55		2,70	200	m
<b>1045879</b>	63x8,6/175	175	63	8,6	0,65	0,65	3,20	200	m
<b>1061041</b>	75x10,3/200	200	75	10,3	0,90		4,00	100	m
<b>1061042</b>	90x12,3/200	200	90	12,3	1,20		4,50	100	m
<b>1061043</b>	110x15,½/200	200	110	15,1	1,30	1,3	5,50	100	m

## Uponor Ecoflex Thermo Twin

- Heating and Cooling
- Two medium pipes PE-Xa with oxygen barrier, SDR 11
- Max. load 6 bar / 95°C
- Coloured centre profil to avoid confusion of flow and return line
- PEX foam, HDPE casing

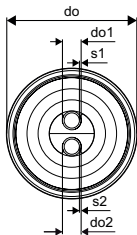

Item no.	Dimension	do mm	do1 mm	do2 mm	s1 mm	s2 mm	R m	R m	Weight kg	Qty 1	UOM
<b>1018134</b>	2x25x2,3/175	175	25	25	2,3	2,3	0,50	0,5	2,20	200	m
<b>1018135</b>	2x32x2,9/175	175	32	32	2,9	2,9	0,60	0,6	2,40	200	m
<b>1018136</b>	2x40x3,7 /175	175	40	40	3,7	3,7	0,80	0,8	2,60	200	m
<b>1018137</b>	2x50x4,6/200	200	50	50	4,6	4,6	1,00	1	3,50	100	m
<b>1018138</b>	2x63x5,8/200	200	63	63	5,8	5,8	1,20	1,2	4,55	100	m

## Uponor Ecoflex Thermo Mini

- Heating and Cooling
- One medium pipe PE-Xa with oxygen barrier, SDR 11
- Max. load 6 bar / 95°C
- PEX foam, HDPE casing

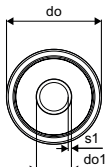

Item no.	Dimension	do mm	do1 mm	s1 mm	R m	Weight kg	Qty 2	Qty 1	UOM
<b>1018132</b>	25x2,3/68	68	25	2,3	0,2	0,50		200	m
<b>1018133</b>	32x2,9/68	68	32	2,9	0,25	0,55		200	m

# Uponor Ecoflex Thermo

## Uponor Ecoflex Thermo Twin HP

- Ideal for heat pump connection, heating and cooling
- Two medium pipe PE-Xa with oxygen barrier, SDR 11
- Two cable conduits for power and data cables
- Max. load 6 bar / 95°C
- Coloured centre profil to avoid confusion of flow and return line
- PEX foam, HDPE casing

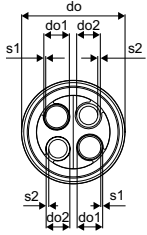

Item no.	Dimension	L m	do mm	do1 mm	do2 mm	s1 mm	s2 mm	R m	Weight kg	Qty 1	UOM
<b>1093894</b>	2x32x2,9-2x32x3,5/140	200	140	32	32	2,9	3,5	0,5	1,66	200	m
<b>1093895</b>	2x40x3,7-2x32x3,5/175	200	175	40	32	3,7	3,5	0,7	2,61	200	m

# Uponor Ecoflex Varia

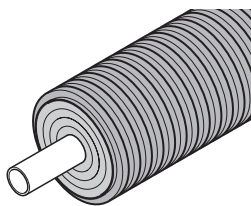

Uponor Ecoflex Varia pipes, certified to European Standard EN 15632, are for heating and cooling applications with reduced outer diameter requirements. Varia Single is for projects that demand large flow

capacity. Varia Twin has supply and return pipes in one jacket. The pipes have long coil lengths and high flexibility for good installation efficiency.

## Your benefits

- Superb flexibility
- Good installation economy
- Can be ordered in specified lengths
- Reliable: 30 years of proven performance
- Full range of fittings and accessories
- Certified system



## Specification

- Flexible, pre-insulated, self-compensating plastic pipe system produced based on EN 15632
- Medium pipe: cross-linked polyethylene (PE-Xa) pipe based on EN ISO 15875, natural coloured, PN 6 (SDR 11) or PN 10 (SDR 7,4), Oxygen tightness based on EN 15632
- Insulating material: closed-cell PE-X foam, permanently elastic, ageing-resistant
- Casing pipe: Corrugated polyethylene (HDPE)

## Application

- Transport of heating and cooling water for buried installations.
- Heating operating temperature 80°C based on EN 15632
- Malfunction temperature 95°C
- Static verification for heavy traffic load of 60 tons

## Certification

- Approvals should be checked by local responsible person

## Uponor Ecoflex Varia Single

- Heating and Cooling
- One medium pipe PE-Xa with oxygen barrier, SDR 11
- Max. load 6 bar / 95°C
- PEX foam, HDPE casing

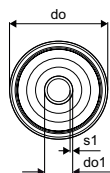

Item no.	Dimension	do mm	do1 mm	s1 mm	R m	R m	Weight kg	Qty 1	UOM
1018230	25x2,3 /90	90	25	2,3	0,25		1,02	200	m
1018231	32x2,9 /90	90	32	2,9	0,30		1,12	200	m
1018232	40x3,7 /140	140	40	3,7	0,35	0,35	1,47	200	m
1018233	50x4,6 /140	140	50	4,6	0,40	0,4	1,67	200	m
1018234	63x5,8 /140	140	63	5,8	0,50	0,5	1,97	200	m
1018235	75x6,8 /175	175	75	6,8	0,60	0,6	2,72	200	m
1018236	90x8,2 /175	175	90	8,2	0,70	0,7	3,14	100	m
1018237	110x10,0 /175	175	110	10	0,90	0,9	4,14	100	m
1062886	125x11,4/200	200	125	11,4	1,40	1,3	5,00	120	m

# Uponor Ecoflex Varia

## Uponor Ecoflex Varia Twin

- Heating and Cooling
- Two medium pipe PE-Xa with oxygen barrier, SDR 11
- Max. load 6 bar / 95°C
- Coloured centre profil to avoid confusion of flow and return line
- PEX foam, HDPE casing

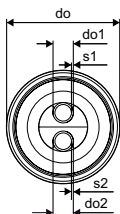

Item no.	Dimension	do mm	do1 mm	do2 mm	s1 mm	s2 mm	R m	R m	Weight kg	Qty 1	UOM
<b>1018238</b>	2x25x2,3/140	140	25	25	2,3	2,3	0,40	0,4	1,36	200	m
<b>1018239</b>	2x32x2,9/140	140	32	32	2,9	2,9	0,50	0,5	1,43	200	m
<b>1018240</b>	2x40x3,7/140	140	40	40	3,7	3,7	0,70	0,7	2,08	200	m
<b>1018241</b>	2x50x4,6/175	175	50	50	4,6	4,6	0,90	0,9	2,84	200	m



# Uponor Ecoflex VIP Aqua

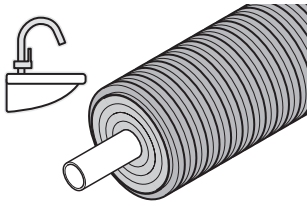

Uponor Ecoflex Aqua pipes are a reliable choice for hygienic and energy-efficient distribution of warm tap water in buried installations. Aqua pipes come in two versions: single pipe for large flow capacity or when one supply

line is sufficient; twin pipe with supply and circulating pipe in the same jacket. The pipes have extremely good insulation performance and flexibility. Available in long coils or in requested length.

## Your benefits

- Clean and hygienic
- Excellent flexibility
- Ease of installation
- Revolutionary energy efficiency
- Proven performance of insulation material
- Full range of accessories and fittings



## Specification

- Flexible, pre-insulated, self-compensating plastic pipe system.
- Medium pipe: cross-linked polyethylene (PE-Xa) pipe based on EN ISO 15875, natural coloured, PN 10 (SDR 7,4)
- Insulating material: Revolutionary insulation material with extremely low lambda value in combination with permanently elastic closed-cell PE-X foam
- Casing pipe: Corrugated polyethylene (HDPE)

## Application

- Transport of warm tap water for buried installations.
- Tap water operating temperature 70°C based on EN 15875
- Malfunction temperature 95°C
- Static verification for heavy traffic load of 60 tons

## Certification

- Approval should be checked by local responsible person

## Uponor Ecoflex VIP Aqua Single

- Warm tap water
- One medium pipe PE-Xa, SDR 7,4
- Max. load 10 bar / 95°C
- VIP + PEX foam, HDPE casing

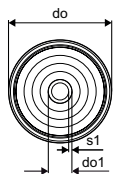

Item no.	Dimension	do mm	do1 mm	s1 mm	R m	Weight kg	Qty 1	UOM
1119047	40x5,5/140	140	40	5,5	0,45	1,84	200	m
1119048	50x6,9/140	140	50	6,9	0,55	2,19	200	m
1119049	63x8,6/140	140	63	8,6	0,65	2,76	200	m
1119050	75x10,3/140	140	75	10,3	0,9	3,33	100	m
1119051	90x12,3/175	175	90	12,3	1,2	4,88	100	m
1119052	110x15,1/175	175	110	15,1	1,3	6,33	100	m

# Uponor Ecoflex VIP Aqua

## Uponor Ecoflex VIP Aqua Twin

- Warm tap water
- Two medium pipe PE-Xa, SDR 7,4
- Max. load 10 bar / 95°C
- VIP + PEX foam, HDPE casing
- Coloured centre profil to avoid confusion of supply and circulation

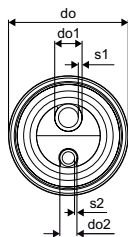

Item no.	Dimension	do mm	do1 mm	do2 mm	s1 mm	s2 mm	R m	Weight kg	Qty 1	UOM
<b>1119053</b>	25x3,5-20x2,8/140	140	25	20	3,5	2,8	0,65	1,74	200	m
<b>1119054</b>	32x4,4-20x2,8/140	140	32	20	4,4	2,8	0,7	1,88	200	m
<b>1119055</b>	40x5,5-25x3,5/140	140	40	25	5,5	3,5	0,9	2,18	200	m
<b>1119056</b>	50x6,9-32x4,4/175	175	50	32	6,9	4,4	1	3,36	200	m

# Uponor Ecoflex Aqua

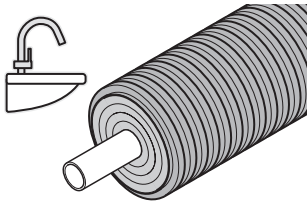

Uponor Ecoflex Aqua pipes are a reliable choice for hygienic and energy-efficient distribution of warm tap water in buried installations. Aqua pipes come in two versions: single pipe for large flow capacity or when one supply

line is sufficient; twin pipe with supply and circulating pipe in the same jacket.

## Your benefits

- Clean and hygienic
- Excellent flexibility
- Ease of installation
- Good heat loss performance
- Reliable: 30 years of proven performance
- Full range of accessories and fittings



## Specification

- Flexible, pre-insulated, self-compensating plastic pipe system.
- Medium pipe: cross-linked polyethylene (PE-Xa) pipe based on EN ISO 15875, natural coloured, PN 10 (SDR 7,4)
- Insulating material: closed-cell PE-X foam, permanently elastic, ageing-resistant
- Casing pipe: Corrugated polyethylene (HDPE)

## Application

- Transport of warm tap water for buried installations.
- Tap water operating temperature 70°C based on EN 15875
- Malfunction temperature 95°C
- Static verification for heavy traffic load of 60 tons

## Certification

- Approval should be checked by local responsible person

## Uponor Ecoflex Aqua Single

- Warm tap water
- One medium pipe PE-Xa, SDR 7,4
- Max. load 10 bar / 95°C
- PEX foam, HDPE casing

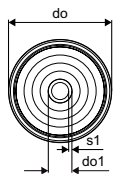

Item no.	Dimension	do mm	do1 mm	s1 mm	R m	R m	Weight kg	Qty 1	UOM
1018117	25x3,5/140	140	25	3,5	0,35	0,35	1,24	200	m
1018118	32x4,4/140	140	32	4,4	0,40	0,4	1,42	200	m
1018119	40x5,5/175	175	40	5,5	0,45	0,45	2,40	200	m
1018120	50x6,9/175	175	50	6,9	0,55	0,55	2,70	200	m
1018121	63x8,6/175	175	63	8,6	0,65	0,65	3,20	200	m

# Uponor Ecoflex Aqua

## Uponor Ecoflex Aqua Twin

- Warm tap water with circulation
- Two medium pipe PE-Xa, SDR 7,4
- Max. load 10 bar / 95°C
- PEX foam, HDPE casing
- Coloured centre profil to avoid confusion of supply and circulation

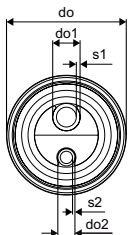

Item no.	Dimension	do mm	do1 mm	do2 mm	s1 mm	s2 mm	R m	R m	Weight kg	Qty 1	UOM
<b>1084885</b>	25x3,5-20x2,8/140	140	25	20	3,5	2,8	0,65	0,65	1,75	200	m
<b>1018139</b>	25x3,5-25x3,5/175	175	25	25	3,5	3,5	0,65	0,65	2,05	200	m
<b>1084886</b>	32x4,4-20x2,8/175	175	32	20	4,4	2,8	0,70	0,7	2,40	200	m
<b>1018140</b>	32x4,4-25x3,5/175	175	32	25	4,4	3,5	0,70	0,7	2,20	200	m
<b>1018141</b>	40x5,5-25x3,5/175	175	40	25	5,5	3,5	0,90	0,9	2,45	200	m
<b>1044015</b>	40x5,5-32x4,4/175	175	40	32	5,5	4,4	0,90		2,80	200	m
<b>1018142</b>	50x6,9-25x3,5/175	175	50	25	6,9	3,5	1,00	1	2,73	200	m
<b>1034188</b>	50x6,9-32x4,4/175	175	50	32	6,9	4,4	1,00		3,10	200	m
<b>1044016</b>	50x6,9-40x5,5/200	200	50	40	6,9	5,5	1,00		3,50	100	m
<b>1044013</b>	50x6,9-50x6,9/200	200	50	50	6,9	6,9	1,00		3,60	100	m

# Uponor Ecoflex Quattro

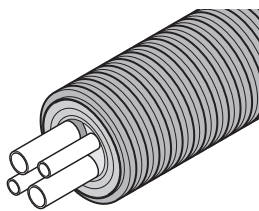

Uponor Ecoflex Quattro is an all-in-one pipe solution for all requirements: extensive supply networks or a single connection to one building. It provides heating, warm tap water supply and circulation pipes in the same jacket:

two flow pipes are intended for domestic warm water and the other two for heating.

## Your benefits

- Cost efficient, all-in-one installation
- Energy efficient
- Easy to install: very flexible
- Corrosion resistant
- Reliable: 30 years of proven performance
- Full range of fittings and accessories



## Specification

- Flexible, pre-insulated, self-compensating plastic pipe system
- Medium pipe: Cross-linked polyethylene (PE-Xa) pipe based on EN ISO 15875, natural coloured, PN 6 (SDR 11) and PN10 (SDR 7,4), Oxygen tightness based on EN 15632 for heating pipes
- Insulating material: closed-cell PE-X foam, permanently elastic, ageing-resistant
- Casing pipe: Corrugated polyethylene (HDPE)

## Application

- Transport of heating and warm tap water for buried installations.
- Heating operating temperature 80°C based on EN 15632
- Tap water operating temperature 70°C based on EN ISO 15875
- Malfunction temperature 95°C
- Static verification for heavy traffic load of 60 tons

## Certification

- Approvals should be checked by local responsible person

# Uponor Ecoflex Quattro

## Uponor Ecoflex Quattro

- Heating and warm tap water with circulation
- Four medium pipe PE-Xa, SDR 11 and 7,4
- Max. load 6 bar heating / 10 bar tap water / 95°C
- PEX foam, HDPE casing
- Coloured centre profil to avoid confusion between the lines

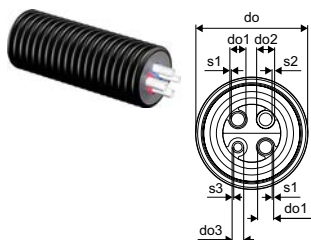

Item no.	Dimension	do mm	do1 mm	do2 mm	do3 mm	s1 mm	s2 mm	s3 mm	R m	R m	Weight kg	Qty 1	UOM
1084887	2x25x2,3-25x3,5-20x2,8/175	175	25	25	20	2,3	3,5	2,8	0,80	0,8	2,30	200	m
1018147	2x25x2,3-2x25x3,5/175	175	25	25	25	2,3	3,5	3,5	0,80	0,8	2,41	200	m
1084888	2x32x2,9-25x3,5-20x2,8/175	175	32	25	20	2,9	3,5	2,8	0,80	0,8	2,50	200	m
1018148	2x32x2,9-2x25x3,5/175	175	32	25	25	2,9	3,5	3,5	0,80	0,8	2,64	200	m
1084889	2x32x2,9-32x4,4-20x2,8/175	175	32	32	20	2,9	4,4	2,8	0,80	0,8	2,90	200	m
1018149	2x32x2,9-32x4,4-25x3,5/175	175	32	32	25	2,9	4,4	3,5	0,80	0,8	2,78	200	m
1044018	2x32x2,9-2x32x4,4/175	175	32	32	32	2,9	4,4	4,4	0,80		2,90	200	m
1084891	2x40x3,7-32x4,4-20x2,8/200	200	40	32	20	3,7	4,4	2,8	1,00	1	3,50	100	m
1084890	2x40x3,7-40x5,5-25x3,5/200	200	40	40	25	3,7	5,5	3,5	1,00	1	3,60	100	m

## Uponor Ecoflex Quattro Midi

- Heating and warm tap water with circulation
- Four medium pipe PE-Xa, SDR 11 and 7,4
- Max. load 6 bar heating / 10 bar tap water / 95°C
- PEX foam, HDPE casing
- One marked heating pipe to avoid confusion of flow and return line

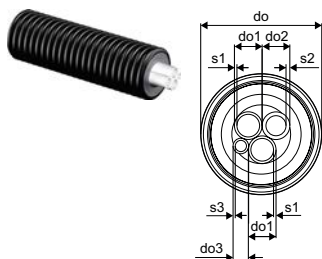

Item no.	Dimension	do mm	do1 mm	do2 mm	do3 mm	s1 mm	s2 mm	s3 mm	R m	Weight kg	Qty 1	UOM
1086836	2x25x2,3-25x3,5-20x2,8/140	140	25	25	20	2,3	3,5	2,8	0,65	1,84	200	m
1086837	2x32x2,9-25x3,5-20x2,8/140	140	32	25	20	2,9	3,5	2,8	0,7	2,00	200	m

# Uponor Ecoflex Supra

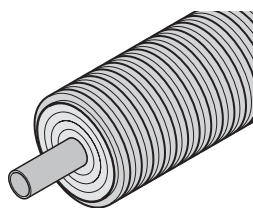

Uponor Ecoflex Supra is designed for cold potable water applications and chilled water distribution for cooling systems. The Uponor Ecoflex Supra Pipes are ideal to deliver cold water to holiday resorts, hotel complexes or

industrial facilities.



## Your benefits

- Clean and hygienic
- Easy to install and very flexible
- Corrosion resistant
- Reliable: 30 years of proven performance
- Full range of fittings and accessories

## Specification

- Flexible, pre-insulated, self-compensating plastic pipe system
- Medium pipe: Polyethylene PE 100, PN 16 (SDR 11) black with blue layer and new in PE100 RC, PN 16 (SDR 11) black with blue stripes
- Insulating material: closed-cell PE-X foam, permanently elastic, ageing-resistant
- Casing pipe: Corrugated polyethylene (HDPE)

## Application

- Transport of cold potable or cooling water for buried installations.
- Operating temperature +20°C
- Static verification for heavy traffic load of 60 tons

## Certification

- Approvals should be checked by local responsible person

## Uponor Ecoflex Supra

- Cold potable water and cooling
- One medium pipe PE 100 RC black, SDR 11
- Max. load 16 bar / 20°C
- PEX foam, HDPE casing

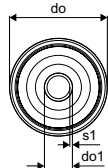

Item no.	Dimension	do mm	do1 mm	s1 mm	R m	Weight kg	Qty 1	UOM
1095722	25x2,3/68	68	25	2,3	0,3	0,52	200	m
1095723	32x2,9/68	68	32	2,9	0,4	1,47	200	m
1095724	40x3,7/140	140	40	3,7	0,5	1,47	200	m
1095725	50x4,6/140	140	50	4,6	0,6	1,67	200	m
1095726	63x5,8/140	140	63	5,8	0,7	1,97	200	m
1095727	75x6,8/175	175	75	6,8	0,9	2,72	150	m
1095728	90x8,2/175	175	90	8,2	1	3,14	100	m
1095729	110x10,0/200	200	110	10	1,2	5,24	100	m

# Uponor Wipex

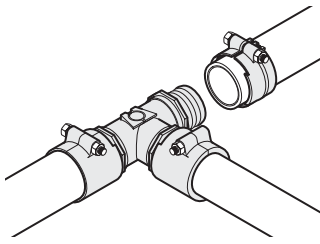

This joining technology connects cross-linked polyethylene pipes for hot and cold water in domestic and district heating installations. The coupling is available in pipe dimensions 25-125mm in two series:

PN 6 and PN 10. The coupler is sealed with an O-ring in 25-110mm and with hemp in 125mm, for quick, reliable installation.

## Your benefits

- Easy to install without hemp
- Corrosion resistant
- Clean and hygienic
- Reliable
- Made of high-quality DR brass



## Specification

- Wipex fittings in corrosion-resistant brass, dezincification based on EN ISO 6509 with stainless steel screw.
- O-ring sealing between Wipex coupling and base fitting connectors
- Bolt set for couplers include a hex socket bolt in stainless steel and the nut as well as washer from brass
- Pre-open sleeve design with assembled support part for the dimension 63-110mm.

## Application

- Fittings for pipe systems Thermo, Aqua, Quattro, Supra, Supra PLUS and Supra Standard
- Connection of PE and PE-Xa medium pipe to couplers with cylindrical inch male thread
- Max. operating temperature 95°C

## Certification

- Approvals should be checked by local responsible person

## Uponor Wipex coupling PN6

- Connection of PE-Xa or PE pipe
- 6 bar, SDR 11
- Cylindric thread G" for O-ring sealing
- DR = dezincification resistance brass

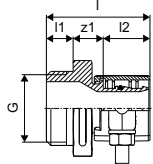

Item no.	Dimension	l mm	l1 mm	l2 mm	G inch	z1 mm	p bar	Weight kg	Qty 2	Qty 1	UOM
1018328	25x2,3-G1	47	12	21	1	14	6	0,20	40	1	pce
1018329	32x2,9-G1	52	12	26	1	14	6	0,30	20	1	pce
1018330	40x3,7-G1 ¼	61	16	30	1 ¼	15	6	0,50	10	1	pce
1018331	50x4,6-G1 ¼	68	16	37	1 ¼	16	6	0,70	10	1	pce
1018332	63x5,8-G2	84	20	47	2	18	6	1,20	8	1	pce
1018333	75x6,8-G2	92	20	51	2	21	6	1,50	6	1	pce
1018334	90x8,2-G3	105	24	60	3	22	6	2,40	4	1	pce
1018335	110x10,0-G3	118	24	72	3	22	6	3,50	3	1	pce



# Uponor Wipex

## Uponor Ecoflex coupling PN6

- Connection of PE-Xa or PE pipe
- 6 bar, SDR 11
- Conical thread R", hemp sealing
- Cannot be used with Wipex fittings!
- DR = dezincification resistance brass

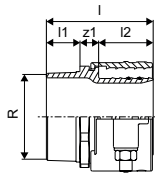

Item no.	Dimension	l mm	l1 mm	l2 mm	R inch	z1 mm	p bar	Weight kg	Qty 1	UOM
<b>1078368</b>	125x11,4-R4	137	43	70	4	24	6	5,24	1	pce

## Uponor Wipex coupling PN10

- Connection of PE-Xa or PE pipe
- 10 bar, SDR 7,4
- Cylindric thread G" for O-ring sealing
- DR = dezincification resistance brass

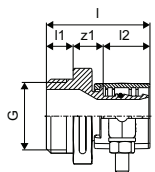

Item no.	Dimension	l mm	l1 mm	l2 mm	G inch	z1 mm	p bar	Weight kg	Qty 2	Qty 1	UOM
<b>1018336</b>	25x3,5-G1	47	12	21	1	14	10	0,20	40	1	pce
<b>1018338</b>	32x4,4-G1	52	12	26	1	14	10	0,30	20	1	pce
<b>1018339</b>	40x5,5-G1 ¼	61	16	30	1 ¼	16	10	0,50	10	1	pce
<b>1018340</b>	50x6,9-G1 ¼	68	16	37	1 ¼	16	10	0,70	10	1	pce
<b>1018341</b>	63x8,6-G2	84	20	46	2	18	10	1,20	8	1	pce
<b>1018342</b>	75x10,3-G2	92	20	51	2	21	10	1,50	6	1	pce
<b>1018343</b>	90x12,3-G3	105	24	59	3	22	10	2,40	4	1	pce
<b>1023170</b>	110x15,1-G3	118	24	72	3	22	10	3,20	3	1	pce

## Uponor Wipex jointing equal PN6

- Connection of PE-Xa or PE pipe
- 6bar, SDR 11
- DR = dezincification resistance brass

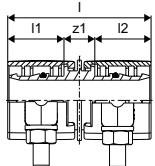

Item no.	Dimension	l mm	l1 mm	l2 mm	z1 mm	p bar	Weight kg	Qty 2	Qty 1	UOM
<b>1042972</b>	25x2,3-25x2,3	54	21	21	12	6	0,18	30	1	pce
<b>1042973</b>	32x2,9-32x2,9	63	26	26	12	6	0,34	25	1	pce
<b>1042980</b>	40x3,7-40x3,7	71	29	29	13	6	0,54	15	1	pce
<b>1042984</b>	50x4,6-50x4,6	85	36	36	13	6	0,99	10	1	pce
<b>1042981</b>	63x5,8-63x5,8	105	46	46	13	6	1,53	5	1	pce
<b>1042985</b>	75x6,8-75x6,8	123	51	51	22	6	2,27	3	1	pce
<b>1042986</b>	90x8,2-90x8,2	142	59	59	24	6	3,50	4	1	pce
<b>1042987</b>	110x10-110x10	166	71	71	24	6	4,82	2	1	pce

# Uponor Wipex

## Uponor Ecoflex coupling PN6

- Connection of PE-Xa or PE pipe
- 6 bar, SDR 11
- DR = dezincification resistance brass

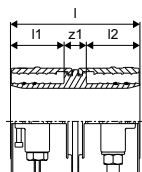

Item no.	Dimension	l mm	l1 mm	l2 mm	z1 mm	p bar	Weight kg	Qty 1	UOM
<b>1078365</b>	125x11,4-125x11,4	169	70	70	29	6	8,15	1	pce

## Uponor Wipex jointing equal PN10

- Connection of PE-Xa or PE pipe
- 10 bar, SDR 7,4
- DR = dezincification resistance brass

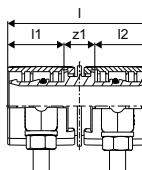

Item no.	Dimension	l mm	l1 mm	l2 mm	z1 mm	p bar	Weight kg	Qty 2	Qty 1	UOM
<b>1042970</b>	25x3,5-25x3,5	54	21	21	12	10	0,18	40	1	pce
<b>1042974</b>	32x4,4-32x4,4	64	26	26	12	10	0,34	25	1	pce
<b>1042979</b>	40x5,5-40x5,5	72	30	29	13	10	0,54	15	1	pce
<b>1042983</b>	50x6,9-50x6,9	86	37	36	13	10	0,96	10	1	pce
<b>1042982</b>	63x8,6-63x8,6	106	47	46	13	10	0,16	4	1	pce

## Uponor Wipex tee

- Cylindric thread G" with sealing ring
- 6 bar, SDR 11 / 10 bar, SDR 7,4
- DR = dezincification resistance brass

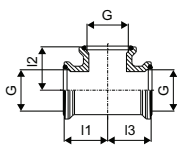

Item no.	Dimension	l1 mm	l2 mm	l3 mm	G mm	G1 inch	G2 inch	p bar	Weight kg	Qty 2	Qty 1	UOM
<b>1018345</b>	G1-G1-G1	35	35	35	1	1	1	6+10	0,31	20	1	pce
<b>1018346</b>	G1 ¼-G1 ¼-G1 ¼	42	42	42	1 ¼	1 ¼	1 ¼	6+10	0,48	10	1	pce
<b>1018347</b>	G2-G2-G2	55	55	55	2	2	2	6+10	1,01	4	1	pce
<b>1018348</b>	G3-G3-G3	75	75	75	3	3	3	6+10	2,64	3	1	pce

# Uponor Wipex

## Uponor Ecoflex tee

- Thread Rp", hemp sealing
- 6 bar, SDR 11 / 10 bar, SDR 7,4
- DR = dezincification resistance brass

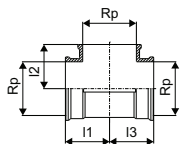

Item no.	Dimension	I1 mm	I2 mm	I3 mm	Rp inch	p bar	Weight kg	Qty 1	UOM
<b>1078367</b>	Rp4-Rp4-Rp4	91	91	91	4	6	3,96	1	pce

## Uponor Wipex elbow

- Cylindric thread G" with sealing ring
- 6 bar, SDR 11 / 10 bar, SDR 7,4
- DR = dezincification resistance brass

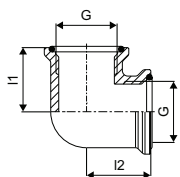

Item no.	Dimension	I1 mm	I2 mm	G inch	G1 inch	p bar	Weight kg	Qty 2	Qty 1	UOM
<b>1018350</b>	G1-G1	35	35	1	1	6+10	0,27	20	1	pce
<b>1018351</b>	G1 ¼-G1 ¼	42	42	1 ¼	1 ¼	6+10	0,45	15	1	pce
<b>1018352</b>	G2-G2	55	55	2	2	6+10	0,94	5	1	pce
<b>1018353</b>	G3-G3	75	75	3	3	6+10	2,20	2	1	pce

## Uponor Ecoflex elbow

- Thread Rp", hemp sealing
- 6 bar, SDR 11 / 10 bar, SDR 7,4
- DR = dezincification resistance brass

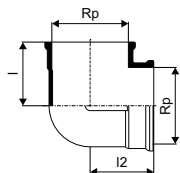

Item no.	Dimension	I1 mm	I2 mm	Rp inch	p bar	Weight kg	Qty 1	UOM
<b>1078366</b>	Rp4-Rp4	92	92	4	6	3,28	1	pce

# Uponor Wipex

## Uponor Wipex sleeve

- Cylindric thread G" with sealing ring
- 6 bar, SDR 11 / 10 bar, SDR 7,4
- DR = dezincification resistance brass

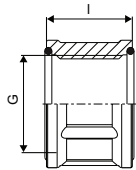

Item no.	Dimension	l mm	G inch	p bar	Weight kg	Qty 2	Qty 1	UOM
<b>1018355</b>	G1-G1	30	1	6+10	0,19	40	1	pce
<b>1018356</b>	G1 ¼-G1 ¼	37	1 ¼	6+10	0,21	25	1	pce
<b>1018357</b>	G2-G2	45	2	6+10	0,42	15	1	pce
<b>1018358</b>	G3-G3	55	3	6+10	0,88	10	1	pce

## Uponor Wipex reducer male x female

- Cylindric thread G" with sealing ring
- 6 bar, SDR 11 / 10 bar, SDR 7,4
- DR = dezincification resistance brass

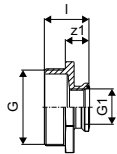

Item no.	Dimension	l mm	G inch	G1 inch	z1 mm	p bar	Weight kg	Qty 2	Qty 1	UOM
<b>1018368</b>	G1 ¼-G1	36	1 ¼	1	20	6+10	0,23	25	1	pce
<b>1018369</b>	G1 ½-G1 ¼	39	1 ½	1 ¼	21	6+10	0,24	25	1	pce
<b>1018371</b>	G2-G1	41	2	1	21	6+10	0,39	15	1	pce
<b>1018372</b>	G2-G1 ¼	45	2	1 ¼	25	6+10	0,40	15	1	pce
<b>1018373</b>	G2 ½-G2	48	2 ½	2	26	6+10	0,65	6	1	pce
<b>1018374</b>	G3-G1	47	3	1	23	6+10	0,87	6	1	pce
<b>1018375</b>	G3-G1 ¼	51	3	1 ¼	27	6+10	0,88	10	1	pce
<b>1018376</b>	G3-G2	55	3	2	31	6+10	0,89	10	1	pce
<b>1009052</b>	G4-G3	58	4	3	30	6+10	1,46	6	1	pce

## Uponor Ecoflex reducer male x female

- Outer conical thread R", hemp sealing
- Inner cylindric thread G" with sealing ring
- 6 bar, SDR 11 / 10 bar, SDR 7,4
- DR = dezincification resistance brass

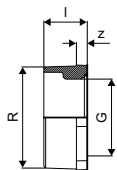

Item no.	Dimension	l mm	G inch	R inch	z mm	p bar	Weight kg	Qty 2	Qty 1	UOM
<b>1078369</b>	R4-G3	48	3	4	12	6	1,40	6	1	pce

# Uponor Wipex

## Uponor Wipex flange

- Cylindric thread G" with sealing ring
- 6 bar, SDR 11 / 10 bar, SDR 7,4
- DR = dezincification resistance brass

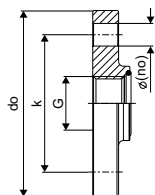

Item no.	Dimension	no. pce	do mm	G inch	k mm	p bar	Weight kg	Qty 2	Qty 1	UOM
<b>1018359*</b>	F25/4-85/G1	4	115	1	85	6+10	1,30	10	1	pce
<b>1018360*</b>	F32/4-100/G1 ¼	4	140	1 ¼	100	6+10	2,00	5	1	pce
<b>1018361</b>	F40/4-110/G1 ½	4	150	1 ½	110	6+10	2,42	5	1	pce
<b>1018362*</b>	F50/4-125/G2	4	165	2	125	6+10	3,04	4	1	pce
<b>1018363</b>	F65/8-145/2 ½	8	185	2 ½	145	6+10	3,74	3	1	pce
<b>1018364*</b>	F80/8-160/G3	8	200	3	160	6+10	4,21	3	1	pce
<b>1018365</b>	F100/8-180/G4	8	220	4	180	6+10	4,55	3	1	pce

## Uponor Ecoflex flange

- Thread Rp", hemp sealing
- 6 bar, SDR 11 / 10 bar, SDR 7,4
- Stainless steel

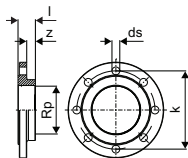

Item no.	Dimension	no. pce	l mm	Rp inch	z mm	k mm	p bar	Weight kg	Qty 1	UOM
<b>1078370*</b>	F100/8-180/Rp4	8	40	4	20	180	6	4,50	1	pce

## Uponor Wipex swivel union

- Rotatable double nipple
- Cylindric thread G" for O-ring sealing
- 6 bar, SDR 11 / 10 bar, SDR 7,4
- DR = dezincification resistance brass

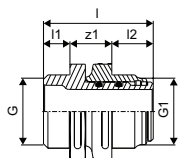

Item no.	Dimension	l mm	l1 mm	l2 mm	G inch	G1 inch	z1 mm	p bar	Weight kg	Qty 2	Qty 1	UOM
<b>1045455</b>	G1	50	12	19	1	1	19	6+10	0,26	20	1	pce
<b>1045456</b>	G1 ¼-G1	50	12	21	1 ¼	1 ¼	17	6+10	0,35	20	1	pce
<b>1045457</b>	G1 ¼	58	16	21	1 ¼	1 ¼	21	6+10	0,50	15	1	pce
<b>1045458</b>	G2-G1 ¼	68	16	25	1 ¼	2	27	6+10	2,00	10	1	pce
<b>1045459</b>	G2	74	20	25	2	2	29	6+10	1,17	10	1	pce
<b>1045460</b>	G3-G2	82	24	25	3	2	33	6+10	1,79	3	1	pce
<b>1045461</b>	G3	89	24	30	3	3	35	6+10	2,75	2	1	pce

# Uponor Wipex

## Uponor Wipex fix point bushing

- Cylindric thread G" with sealing ring
- 6 bar, SDR 11 / 10bar, SDR 7,4
- DR = dezincification resistance brass

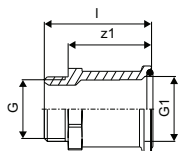

Item no.	Dimension	l mm	G inch	G1 inch	z1 mm	p bar	Weight kg	Qty 2	Qty 1	UOM
<b>1018302*</b>	G1	54	1	1	42	6+10	0,23	30	1	pce
<b>1018303</b>	G1 ¼	84	1 ¼	1 ¼	68	6+10	0,45	10	1	pce
<b>1018304</b>	G2	93	2	2	73	6+10	0,78	5	1	pce
<b>1018305*</b>	G3	135	3	3	111	6+10	2,15	5	1	pce

## Uponor Wipex adapter S-Press PN6

- Connetion of PE-Xa pipe to Uponor MLC pipe.
- 6 bar
- DR = dezincification resistance brass

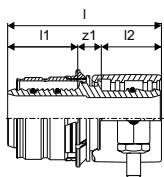

Item no.	Dimension	l mm	l1 mm	l2 mm	do mm	s mm	z1 mm	p bar	Weight kg	Qty 2	Qty 1	UOM
<b>1060058</b>	32x2,9-32x3,0	66	30	26	15	2,5	10	6	0,24	25	1	pce

## Uponor Wipex adapter S-Press PN6

- Connection of PE-Xa pipe to Uponor MLC pipe.
- 6 bar
- DR = dezincification resistance brass

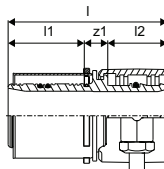

Item no.	Dimension	l mm	l1 mm	l2 mm	do mm	s mm	z1 mm	p bar	Weight kg	Qty 2	Qty 1	UOM
<b>1060059</b>	40x3,7-40x4,0	79	38	30	18	2,5	12	6	0,41	15	1	pce
<b>1060060</b>	50x4,6-50x4,5	86	38	37	18	2,5	12	6	0,66	10	1	pce

# Uponor Wipex

## Uponor Wipex RS adapter PN6

- RS = unique modular fitting connection
- 6 bar, SDR 11
- DR = dezincification resistance brass

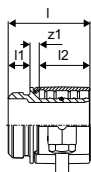

Item no.	Dimension	l mm	l1 mm	l2 mm	z1 mm	p bar	Weight kg	Qty 2	Qty 1	UOM
<b>1047013</b>	DR 63x5,8 RS2	75	46	20	9	6	0,94	240	1	pce
<b>1047014</b>	DR 75x6,8 RS2	84	46	20	18	6	1,28	240	1	pce
<b>1047015</b>	DR 90x8,2 RS3	93	59	20	14	6	2,07	180	1	pce
<b>1047016</b>	DR 110x10,0 RS3	105	71	20	14	6	2,67	180	1	pce

## Uponor Wipex RS adapter PN10

- RS = unique modular fitting connection
- 10 bar, SDR 7,4
- DR = dezincification resistance brass

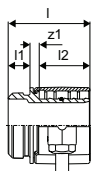

Item no.	Dimension	l mm	l1 mm	l2 mm	z1 mm	p bar	Weight kg	Qty 2	Qty 1	UOM
<b>1047017</b>	DR 63x8,6 RS2	75	20	46	9	10	0,95	240	1	pce
<b>1047018</b>	DR 75x10,3 RS2	83	20	51	12	10	1,33	240	1	pce
<b>1047019</b>	DR 90x12,3 RS3	92	20	59	13	10	2,21	180	1	pce
<b>1047020</b>	DR 110x15,1 RS3	104	20	71	13	10	3,01	180	1	pce

## Uponor Wipex sleeve plier

- Expansion tool for the WIPEX coupling sleeve



Item no.	Dimension	l mm	Weight kg	Qty 2	Qty 1	UOM
<b>1046407</b>	1 - 1 ½	145	0,15	25	1	pce
<b>1046408</b>	1 ½ - 3 ½	200	0,23	25	1	pce

# Uponor Wipex

## Uponor RS adapter PL Q&E

- RS
- Positive listed brass
- Uponor Q&E Ring must be ordered separately



Item no.	Dimension	l mm	l1 mm	l2 mm	z1 mm	p mm bar	Qty 2	Qty 1	UOM
<b>1047021</b>	25-RS2	50	20	27	3	6+10	480	1	pce
<b>1047022</b>	32-RS2	57	20	34	3	6+10	480	1	pce
<b>1047023</b>	40-RS2	65	20	42	3	6+10	480	1	pce
<b>1047024</b>	50-RS2	75	20	52	3	6+10	400	1	pce

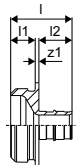

## Uponor RS adapter PL Q&E

- RS
- Positive listed brass
- Uponor Q&E Ring must be ordered separately



Item no.	Dimension	l mm	l1 mm	l2 mm	z1 mm	p mm bar	Qty 2	Qty 1	UOM
<b>1047026</b>	63-RS2	88	20	65	3	6+10	400	1	pce

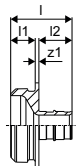

## Uponor RS coupling

- Made of tin-plated brass
- Base part for all RS2 or RS3 inserts including 2 lock pins.



Item no.	Dimension	l mm	Qty 2	Qty 1	UOM
<b>1029144</b>	RS2-RS2	58	480	1	pce
<b>1029145</b>	RS3-RS3	58	480	1	pce

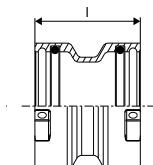



# Uponor Wipex

## Uponor RS tee

- Made of tin-plated brass
- Base part for all RS2 or RS3 inserts including 3 lock pins.

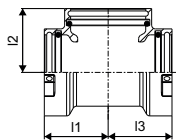

Item no.	Dimension	l1 mm	l2 mm	l3 mm	Qty 2	Qty 1	UOM
<b>1029142</b>	RS2-RS2-RS2	51	51	51	336	1	pce
<b>1029143</b>	RS3-RS3-RS3	68	68	68	175	1	pce

## Uponor RS elbow

- Made of tin-plated brass
- Base part for all RS2 or RS3 inserts including 2 lock pins.

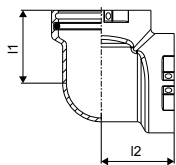

Item no.	Dimension	l1 mm	l2 mm	Qty 2	Qty 1	UOM
<b>1029138</b>	RS2-RS2	51	51	336	1	pce
<b>1029139</b>	RS3-RS3	68	68	240	1	pce

## Uponor RS elbow 45

- Made of tin-plated brass
- Base part for all RS2 or RS3 inserts including 2 lock pins.

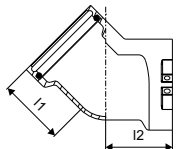

Item no.	Dimension	l1 mm	l2 mm	Qty 2	Qty 1	UOM
<b>1029140</b>	RS2-RS2	51	51	336	1	pce
<b>1029141</b>	RS3-RS3	68	68	175	1	pce

# Uponor Wipex

## Uponor RS reducer

- Made of tin-plated brass
- Reducer from RS3 to RS2 including 1 lock pin.

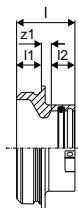

Item no.	Dimension	l	l1	l2	z1	Qty 2	Qty 1	UOM
		mm	mm	mm	mm			
<b>1029146</b>	RS3-RS2	47	20	19	8	480	1	pce

## Uponor RS adapter female thread

- Made of tin-plated brass.
- its to all RS2 or RS3 base parts

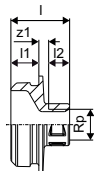

Item no.	Dimension	l	l1	l2	Rp	z1	Qty 2	Qty 1	UOM
		mm	mm	mm	inch	mm			
<b>1029134</b>	Rp1"FT-RS2	45	20	19	1	6	480	1	pce
<b>1029135</b>	Rp2"FT-RS2	54	20	26	2	8	480	1	pce
<b>1029136</b>	Rp2 1/2"FT-RS2	63	20	30	2 1/2	12	480	1	pce
<b>1029137</b>	Rp3"FT-RS3	65	20	33	3	12	240	1	pce

## Uponor RS adapter male thread

- Made of tin-plated brass
- Fits to all RS2 or RS3 base parts

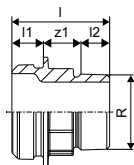

Item no.	Dimension	l	l1	l2	R	z1	Qty 2	Qty 1	UOM
		mm	mm	mm	inch	mm			
<b>1029131</b>	R2"MT-RS2	66	20	23	2	23	480	1	pce
<b>1029132</b>	R2 1/2"MT-RS2	63	20	27	2 1/2	16	480	1	pce
<b>1029133</b>	R3"MT-RS3	73	20	30	3	23	240	1	pce

# Uponor Wipex

## Uponor RS flange adapter

- Made of tin-plated brass
- Fits to all RS2 or RS3 base parts
- Flange PN6/PN16 acc. to EN 1092-3
- Bolt circle with 4/8 holes.



Item no.	Dimension	l mm	di mm	do mm	z1 mm	k mm	p bar	Qty 2	Qty 1	UOM
<b>1029129</b>	RS3-DN80 (PN16)	45	78,1	200	25	160	16	90	1	pce
<b>1029130</b>	RS3-DN100 (PN16)	44	78,1	220	24	180	16	90	1	pce

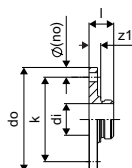

## Uponor RS spacer

- Made of tin-plated brass
- Spacer to connect RS base parts of equal dimensions e.g to create T-manifold or shift in distribution lines.



Item no.	Dimension	l mm	l1 mm	l2 mm	l3 mm	z1 mm	Qty 2	Qty 1	UOM
<b>1046477</b>	RS2-RS2 l=130mm	170	20	20	30	130	240	1	pce
<b>1046478</b>	RS3-RS3 l=210mm	250	20	20	30	210	96	1	pce

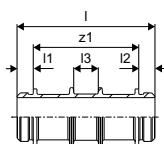

## Uponor RS spacer

- Made of tin plated-brass
- Spacer to connect RS base parts of equal dimensions.



Item no.	Dimension	l mm	l1 mm	l2 mm	z1 mm	Qty 2	Qty 1	UOM
<b>1046750</b>	RS2-RS2 l=5mm	45	20	20	5	480	1	pce
<b>1046751</b>	RS3-RS3 l=5mm	45	20	20	5	240	1	pce

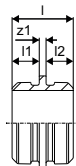

# Uponor Wipex

## Uponor RS adapter S-Press

- Made of tin-plated brass
- Fits to all RS2 or RS3 base parts.

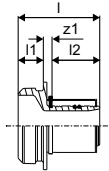

Item no.	Dimension	l mm	l1 mm	l2 mm	z1 mm	Qty 2	Qty 1	UOM
<b>1046940</b>	40-RS2	65	20	38	7	480	1	pce
<b>1046941</b>	50-RS2	65	20	38	7	480	1	pce
<b>1029125</b>	63-RS2	88	20	61	7	400	1	pce
<b>1029126</b>	75-RS2	88	20	61	7	400	1	pce
<b>1029127</b>	90-RS3	93	20	62	11	240	1	pce
<b>1029128</b>	110-RS3	93	20	62	11	240	1	pce

## Uponor RS lock pin

- made of plastic
- to lock the RS insert to the RS base part.



Item no.	Dimension	colour	Qty 2	Qty 1	UOM
<b>1042921</b>	RS2 black	black	5000	10	pce
<b>1042922</b>	RS3 grey	grey		10	pce

# Uponor Q&E

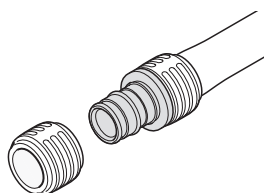

Uponor Q&E is a unique and innovative fittings system that uses the shrink-back effect of cross-linked polyethylene PE-Xa pipes for quick and easy installation. A wide range of fittings and accessories makes Q&E a

complete and secure system for cost-effective installation. Corrosion resistance makes it safe, secure and watertight.

## Your benefits

- Fast and reliable mounting
- Corrosion resistant
- Low pressure loss
- Ergonomic design of ring
- Easy identification of ring dimension



## Certification

- Approvals should be checked by local responsible person

## Uponor Q&E evolution ring white

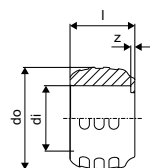

Item no.	Dimension	l mm	di mm	do mm	z mm	p bar	colour	Qty 2	Qty 1	UOM
<b>1057455</b>	25	25	25,3	34,6	1	6+10	white	300	20	pce
<b>1057456</b>	32	32	32,4	41,8	1	6+10	white	150	10	pce

## Uponor Q&E ring with stop edge natural

- With stop edge
- Pex material

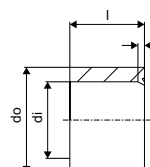

Item no.	Dimension	l mm	di mm	do mm	z mm	p bar	colour	Qty 2	Qty 1	UOM
<b>1045464</b>	40	41	40,8	50,2	3	6+10	natural	80	5	pce
<b>1045489</b>	50	50	51	63	4	6+10	natural	70	5	pce
<b>1045490</b>	63	63	64,3	75,7	4	6+10	natural	35	5	pce
<b>1085087</b>	75	76	76,3	88,3	4	6+10	natural	18	2	pce

# Uponor Q&E

## Uponor Q&E elbow PPSU

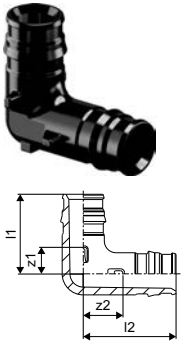

Item no.	Dimension	l1 mm	l2 mm	z1 mm	z2 mm	p bar	Qty 2	Qty 1	UOM
<b>1008681</b>	25-25	42	47	14	19	6+10	25	5	pce
<b>1001245</b>	32-32	53	59	18	23	6+10	10	1	pce
<b>1008683</b>	40-40	65	74	21	29	6+10	10	1	pce
<b>1042859</b>	50-50	83	98	29	44	6+10	5	1	pce
<b>1042858</b>	63-63	100	112	33	44	6+10	3	1	pce
<b>1085080</b>	75-75	149	149	64	65	6+10	2	1	pce

## Uponor Q&E coupling PPSU

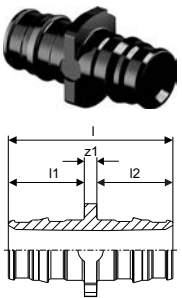

Item no.	Dimension	l mm	l1 mm	l2 mm	z1 mm	p bar	Qty 2	Qty 1	UOM
<b>1008671</b>	25-25	58	28	28	3	6+10	50	5	pce
<b>1001235</b>	32-32	73	35	35	3	6+10	15	1	pce
<b>1008673</b>	40-40	90	44	44	3	6+10	10	1	pce
<b>1042866</b>	50-50	113	54	54	5	6+10	10	1	pce
<b>1042865</b>	63-63	141	68	68	6	6+10	5	1	pce
<b>1085084</b>	75-75	179	86	86	7	6+10	10	1	pce

## Uponor Q&E reducer PPSU

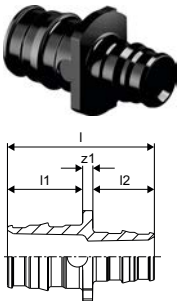

Item no.	Dimension	l mm	l1 mm	l2 mm	z1 mm	p bar	Qty 2	Qty 1	UOM
<b>1001240</b>	32-25	66	28	35	3	6+10	20	1	pce
<b>1008678</b>	40-32	82	35	44	3	6+10	10	1	pce
<b>1042879</b>	50-32	94	54	35	5	6+10	10	1	pce
<b>1042867</b>	50-40	103	54	44	5	6+10	10	1	pce
<b>1042878</b>	63-40	117	68	44	6	6+10	5	1	pce
<b>1042877</b>	63-50	128	68	54	6	6+10	5	1	pce
<b>1085086</b>	75-50	147	86	54	6	6+10	10	1	pce
<b>1085085</b>	75-63	160	86	68	7	6+10	10	1	pce

## Uponor Q&E tee PPSU

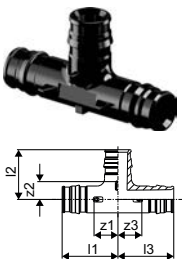

Item no.	Dimension	l1 mm	l2 mm	l3 mm	z1 mm	z2 mm	z3 mm	p bar	Qty 2	Qty 1	UOM
<b>1008686</b>	25-25-25	47	42	47	20	15	20	6+10	20	5	pce
<b>1001250</b>	32-32-32	59	53	59	24	18	24	6+10	10	1	pce
<b>1008688</b>	40-40-40	74	65	74	30	22	30	6+10	5	1	pce
<b>1042861</b>	50-50-50	92	83	92	38	29	38	6+10	3	1	pce
<b>1042860</b>	63-63-63	112	102	112	44	5	44	6+10	2	1	pce
<b>1085081</b>	75-75-75	156	123	156	70	37	70	6+10	2	1	pce

# Uponor Q&E

## Uponor Q&E tee reducer PPSU

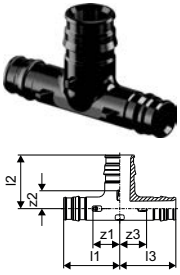

Item no.	Dimension	l1 mm	l2 mm	l3 mm	z1 mm	z2 mm	z3 mm	p bar	Qty 2	Qty 1	UOM
1008712	25-32-25	52	50	52	24	15	24	6+10	15	1	pce
1001426	32-25-25	55	45	47	20	18	20	6+10	15	1	pce
1001428	32-25-32	55	45	55	20	18	20	6+10	15	1	pce
1008713	32-40-32	65	61	65	30	18	30	6+10	10	1	pce
1008708	40-25-32	63	49	55	20	22	20	6+10	5	1	pce
1008695	40-25-40	63	49	63	20	22	20	6+10	5	1	pce
1008709	40-32-32	68	57	59	24	22	24	6+10	5	1	pce
1008696	40-32-40	68	57	68	24	22	24	6+10	5	1	pce
1042876	50-25-40	92	57	82	38	29	39	6+10	4	1	pce
1042864	50-25-50	92	57	92	38	29	38	6+10	4	1	pce
1042863	50-32-50	92	64	92	38	29	38	6+10	4	1	pce
1042862	50-40-40	92	73	82	38	29	39	6+10	4	1	pce
1042875	50-40-50	92	73	92	38	29	38	6+10	4	1	pce
1042871	63-25-50	112	62	99	44	35	45	6+10	2	1	pce
1042873	63-25-63	112	60	112	44	33	44	6+10	2	1	pce
1042870	63-32-63	112	70	112	44	35	44	6+10	2	1	pce
1042869	63-40-40	112	78	99	44	35	55	6+10	2	1	pce
1042872	63-40-63	112	78	112	44	35	44	6+10	2	1	pce
1042868	63-50-50	112	89	99	44	35	45	6+10	2	1	pce
1042874	63-50-63	112	89	112	44	35	44	6+10	2	1	pce
1085083	75-25-75	118	67	118	32	39	32	6+10	4	1	pce
1085082	75-40-75	118	83	118	32	83	32	6+10	4	1	pce

## Uponor Q&E adapter male thread PL

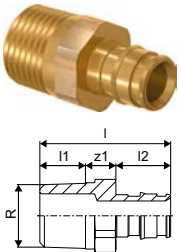

Item no.	Dimension	l mm	l1 mm	l2 mm	R inch	z1 mm	p bar	Qty 2	Qty 1	UOM
1023007	25-R $\frac{3}{4}$ "MT	55	17	27	$\frac{1}{2}$	11	6+10	70	5	pce
1047191	32-R1"MT	65	21	34	$\frac{3}{4}$	10	6+10	10	1	pce

## Uponor Q&E adapter male thread PL/DR

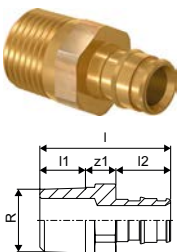

Item no.	Dimension	l mm	l1 mm	l2 mm	R inch	z1 mm	p bar	Qty 2	Qty 1	UOM
1085077	40-R1 $\frac{1}{4}$ "MT	73	19	42	1 $\frac{1}{4}$	12	6+10	16	1	pce
1085076	50-R1 $\frac{1}{2}$ "MT	89	20	52	1 $\frac{1}{2}$	17	6+10	8	1	pce
1085075	63-R2"MT	100	24	65	2	11	6+10	6	1	pce
1085074	75-R2 $\frac{1}{2}$ "MT	126	27	86	2 $\frac{1}{2}$	13	6+10	6	1	pce

# Uponor Q&E

## Uponor Q&E adapter male thread PL

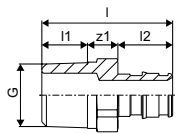

Item no.	Dimension	l mm	l1 mm	l2 mm	G inch	z1 mm	p bar	Qty 2	Qty 1	UOM
<b>1047862</b>	25-G $\frac{3}{4}$ "MT	48	11	27	$\frac{3}{4}$	10	6+10	40	5	pce
<b>1047863</b>	25-G1"MT	49	11	27	1	11	6+10	40	5	pce
<b>1047864</b>	50-G1 $\frac{1}{2}$ "MT	82	17	52	1 $\frac{1}{2}$	13	6+10	8	1	pce

## Uponor Q&E adapter male thread PL W

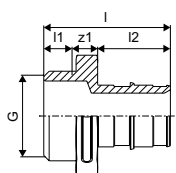

Item no.	Dimension	l mm	l1 mm	l2 mm	G inch	z1 mm	p bar	Qty 2	Qty 1	UOM
<b>1008730</b>	32-G1"MT	56	10	34	1	12	6+10	20	1	pce
<b>1022290</b>	40-G1"MT	64	11	42	1	11	6+10	16	1	pce
<b>1008732</b>	40-G1 $\frac{1}{4}$ "MT	68	14	42	1 $\frac{1}{4}$	12	6+10	8	1	pce
<b>1008866</b>	50-G1 $\frac{1}{4}$ "MT	78	14	52	1 $\frac{1}{4}$	12	6+10	8	1	pce
<b>1008867</b>	63-G2"MT	95	17	65	2	13	6+10	6	1	pce

## Uponor Q&E adapter male thread DR W

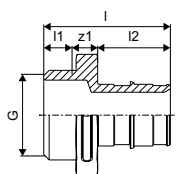

Item no.	Dimension	l mm	l1 mm	l2 mm	G inch	z1 mm	p bar	Qty 2	Qty 1	UOM
<b>1063810</b>	25-G1"MT	47	11	27	1	9	6+10	35	5	pce
<b>1063724</b>	32-G1"MT	56	10	34	1	12	6+10	10	1	pce
<b>1063725</b>	40-G1 $\frac{1}{4}$ "MT	68	14	42	1 $\frac{1}{4}$	12	6+10	16	1	pce
<b>1063727</b>	50-G1 $\frac{1}{4}$ "MT	78	14	52	1 $\frac{1}{4}$	12	6+10	8	1	pce
<b>1063728</b>	63-G2"MT	95	17	65	2	13	6+10	6	1	pce

## Uponor Q&E elbow adapter female thread PL

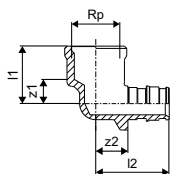

Item no.	Dimension	l1 mm	l2 mm	G inch	z1 mm	z2 mm	p bar	Qty 2	Qty 1	UOM
<b>1023026</b>	25-G $\frac{3}{4}$ "FT	26	44	$\frac{3}{4}$	10	17	6+10	35	5	pce



# Uponor Q&E

## Uponor Q&E adapter female thread PL

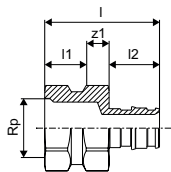

Item no.	Dimension	l	l1	l2	Rp	z1	p	Qty 2	Qty 1	UOM
		mm	mm	mm	inch	mm	bar			
<b>1023012</b>	25-Rp $\frac{3}{4}$ "FT	51	18	27	$\frac{3}{4}$	6	6+10	40	5	pce
<b>1023013</b>	25-Rp1"FT	55	22	27	1	6	6+10	35	5	pce

## Uponor Q&E adapter female thread PL

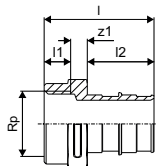

Item no.	Dimension	l	l1	l2	G	z1	p	Qty 2	Qty 1	UOM
		mm	mm	mm	inch	mm	bar			
<b>1047866</b>	32-G1"FT	56	13	34	1	9	6+10	20	1	pce
<b>1047867</b>	40-G1 $\frac{1}{4}$ "FT	68	16	42	1 $\frac{1}{4}$	10	6+10	20	1	pce

## Uponor Q&E adapter female thread PL/DR

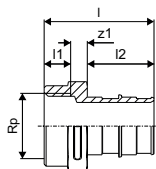

Item no.	Dimension	l	l1	l2	Rp	z1	p	Qty 2	Qty 1	UOM
		mm	mm	mm	inch	mm	bar			
<b>1085078</b>	50-RP1 $\frac{1}{2}$ "FT	92	21	52	1 $\frac{1}{2}$	19	6+10	8	1	pce

# Uponor Ecoflex

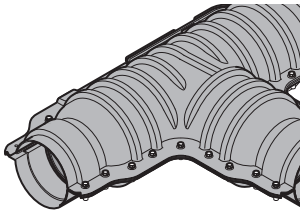

The Uponor Ecoflex system includes all accessories for complete heating, cooling networks as well as for potable water and warm tap water supply.

The accessories are designed to complement the

Uponor Ecoflex pipes and fittings.

## Your benefits

- Practical and easy to install components
- Robust, reliable and safe
- Full range of components for all installation needs



## Specification

- All accessories are corrosion resistant.

## Application

- Ecoflex accessories are designed to complete the assortment in buried installation.

## Certification

- Approvals should be checked by local responsible person

## Uponor Ecoflex rubber end cap Single

- For one medium pipe
- Protect the pipe end against moisture and dirt
- Watertight up to 0,3 bar
- Contain EPDM rubber cap, stainless steel and sealing ring

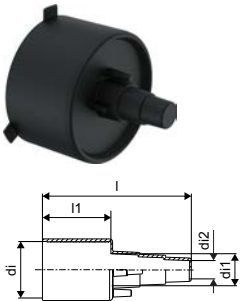

Item no.	Dimension	l mm	l1 mm	di mm	di1 mm	di2 mm	Weight kg	Qty 1	UOM
1018316	25+32+40/68	174	80	68	40	25	0,15	1	pce
1018246	25+32+40/90	174	80	90	40	25	0,19	1	pce
1018315	25+28+32/140	184	90	140	32	25	0,33	1	pce
1036248	32+40+50/90	174	80	90	50	32	0,19	1	pce
1018313	32+40+50/175	184	90	175	50	32	0,42	1	pce
1018314	40+50+63/140	184	90	140	63	40	0,34	1	pce
1095801	63+75+90/140	184	90	140	90	63	0,37	1	pce
1018312	63+75/175	184	90	175	75	63	0,44	1	pce
1018310	75+90+110/200	184	90	200	110	75	0,51	1	pce
1018311	90+110/175	184	90	175	110	90	0,46	1	pce
1067757	125/200	142	90	200	125	109	0,55	1	pce

# Uponor Ecoflex

## Uponor Ecoflex rubber end cap Twin

- For two medium pipes
- Protect the pipe end against moisture and dirt
- Watertight up to 0,3 bar
- Contain EPDM rubber cap, stainless steel and sealing ring

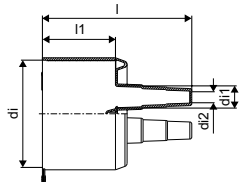

Item no.	Dimension	l mm	l1 mm	di mm	di1 mm	di2 mm	Weight kg	Qty 1	UOM
<b>1119374</b>	18-22+25-28+32/140	184	90	140	32	18	0,35	1	pce
<b>1018245</b>	25+32+40/140	184	90	140	40	25	0,36	1	pce
<b>1018309</b>	25+32+40/175	184	90	175	40	25	0,44	1	pce
<b>1018308</b>	25+32+50/175	184	90	175	50	25	0,45	1	pce
<b>1018307</b>	40+50+63/200	184	90	200	63	40	0,52	1	pce
<b>1088979</b>	75+90/250	194	90	250	90	75	0,80	1	pce

## Uponor Ecoflex rubber end cap Quattro

- For four medium pipes
- Protect the pipe end against moisture and dirt
- Watertight up to 0,3 bar
- Contain EPDM rubber cap, stainless steel and sealing ring

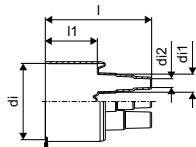

Item no.	Dimension	l mm	l1 mm	di mm	di1 mm	di2 mm	Weight kg	Qty 1	UOM
<b>1086838</b>	20+25+32/140	184	90	140	32	20	0,45	1	pce
<b>1018306</b>	18-32+25-32/175	184	90	175	32	18	0,49	1	pce
<b>1094252</b>	25+32+40/175	184	90	175	40	25	0,55	1	pce

## Uponor Ecoflex tee insulation set

- Tee-set for connecting the casing pipe
- ABS half sheels with insulation and reducer

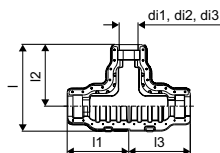

Item no.	Dimension	l mm	l1 mm	l2 mm	l3 mm	di1 mm	di2 mm	di3 mm	Weight kg	Qty 2	Qty 1	UOM
<b>1060986</b>	140/90/68	666	470	470	470	140	90	68	9,77	5	1	pce
<b>1060982</b>	200/175/140	786	562	562	562	200	175	140	13,53	4	1	pce

# Uponor Ecoflex

## Uponor Ecoflex elbow insulation set

- Elbow set for connecting the casing pipe
- ABS half shells with insulation and reducer
- Traffic load of 60 tons

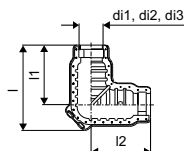

Item no.	Dimension	l mm	l1 mm	l2 mm	di1 mm	di2 mm	di3 mm	Weight kg	Qty 2	Qty 1	UOM
<b>1060985</b>	200/175/140	806	563	563	200	175	140	10,55	3	1	pce

## Uponor Ecoflex coupling insulation set

- Straight set for connecting the casing pipe
- ABS half shells with insulation and reducer

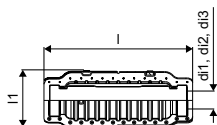

Item no.	Dimension	l mm	l1 mm	di1 mm	di2 mm	di3 mm	Weight kg	Qty 2	Qty 1	UOM
<b>1060984</b>	200/175/140	1125	426	200	175	140	9,66	6	1	pce

## Uponor Ecoflex tee connection shell

- Tee-set for connecting the casing pipe
- ABS half shells without foam shells and reducers
- Traffic load of 60 tons

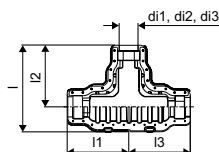

Item no.	Dimension	l mm	l1 mm	l2 mm	l3 mm	di1 mm	di2 mm	di3 mm	Weight kg	Qty 2	Qty 1	UOM
<b>1090041</b>	200/175/140	786	562	562	562	200	175	140	10,90	4	1	pce

# Uponor Ecoflex

## Uponor Ecoflex reducer ring

- Balance different casing pipe dimensions in an insulation set

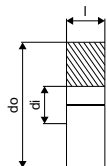

Item no.	Dimension	l mm	di mm	do mm	Weight kg	Qty 2	Qty 1	UOM
<b>1060991</b>	200/68	70	68	229	0,09	8	1	pce
<b>1060990</b>	200/90	70	90	229	0,08	8	1	pce
<b>1060989</b>	200/140	70	140	229	0,07	12	1	pce
<b>1060988</b>	200/175	70	175	229	0,04	12	1	pce
<b>1060987</b>	200	70	200	229	0,03	12	1	pce

## Uponor Ecoflex jacket joint set

- Straight set for connecting of casing pipe  
 - Pipe piece with two shink sleeves  
 - Traffic load 60 tons

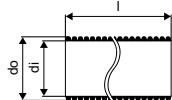

Item no.	Dimension	l mm	di mm	do mm	Weight kg	Qty 1	UOM
<b>1090231</b>	140	550	175	200	1,50	1	pce
<b>1084574</b>	175+200	650	218	250	2,80	10	pce
<b>1083872</b>	250	720	275	315	4,70	9	pce

## Uponor Ecoflex H-insulation set

- H-set for connecting the casing pipe from single to twin lines  
 - ABS half sheels with insulation and reducer spigots  
 - Additional rubber end caps needed for tightness  
 - Traffic load with special concret construction possible

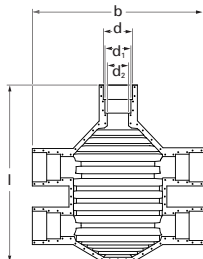

Item no.	Dimension	d mm	d1 mm	d2 mm	l mm	b mm	Weight kg	Qty 1	UOM
<b>1007355</b>	200/175/140	200	175	140/145	1290	1260	19,00	1	pce

## Uponor Ecoflex shrink sleeve

- Seal casing pipe with chamber or other casing outlets

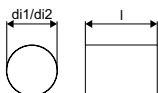

Item no.	Dimension	l mm	di1 mm	di2 mm	Weight kg	Qty 1	UOM
<b>1018379</b>	140	300	220	135	0,30	1	pce
<b>1018380</b>	175/200	300	270	160	0,55	1	pce
<b>1084575</b>	250	300	335	222	0,72	15	pce

# Uponor Ecoflex

## Uponor Ecoflex wall seal PWP

- For concrete core hole or fibre cement pipe
- Part to seal the casing pipe
- Applicable for PWP (pressurized water)
- Watertight up to 0,3bar

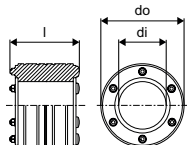

Item no.	Dimension	l mm	di mm	do mm	Weight kg	Qty 1	UOM
<b>1007360</b>	140	110	145	200	2,42	1	pce
<b>1007361</b>	175	110	175	250	3,70	1	pce
<b>1007362</b>	200	110	200	300	4,90	1	pce

**di = jacket pipe diameter**  
**do = core hole drilling**

## Uponor Ecoflex additional insert

- For concrete core hole or fibre cement pipe
- Part to eliminate radial stress of the casing pipe
- Use with Uponor wall seal PWP only
- di = jacket pipe diameter
- do = core hole drilling

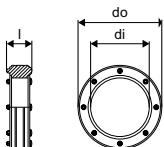

Item no.	Dimension	l mm	di mm	do mm	Weight kg	Qty 1	UOM
<b>1007365</b>	140	65	140	200	1,43	1	pce
<b>1007366</b>	175	65	175	250	2,30	1	pce
<b>1007367*</b>	200	65	200	300	3,30	1	pce

## Uponor Ecoflex fibre cement pipe PWP

- Embed in a brick wall or concrete wall
- Alternative to water-proof concrete core hole
- Applicable for Uponor wall seal PWP (pressurized water)
- „Dimension“ = used for jacket pipe diameter

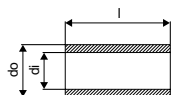

Item no.	Dimension	l mm	di mm	do mm	Weight kg	Qty 1	UOM
<b>1007370</b>	140	400	200	250	15,20	1	pce
<b>1007371</b>	175	400	250	300	18,80	1	pce
<b>1007372</b>	200	400	300	350	22,00	1	pce

# Uponor Ecoflex

## Uponor Ecoflex epoxy resin set PWP

- Pre-treatment of the concrete core hole surface
- Applicable for Uponor wall seal PWP (pressurized water)



Item no.	Dimension	Weight kg	Qty 1	UOM
<b>1007373</b>	1,1 kg/3,5m <sup>2</sup>	1,45	1	set

## Uponor Ecoflex wall sleeve set NPW

- For concrete-cast and brick walls
- Applicable for NPW = no pressurized water area
- Contain PE pipe and shrink sleeve

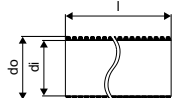

Item no.	Dimension	l mm	di mm	do mm	Weight kg	Qty 1	UOM
<b>1018267</b>	68+90	550	95	110	1,00	1	pce
<b>1018269</b>	140	550	175	200	1,30	1	pce
<b>1018268</b>	175+200	550	218	250	1,90	1	pce
<b>1083871</b>	250	550	275	315	2,90	16	1 pce

## Uponor Ecoflex wall through sealing

- For concrete-cast and brick walls
- Prevents moisture from entering the building
- Applicable for NPW = no pressurized water area

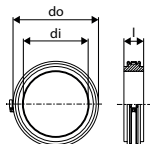

Item no.	Dimension	l mm	di mm	do mm	Weight kg	Qty 2	Qty 1	UOM
<b>1034202</b>	140	40	140	190	0,35	40	1	pce
<b>1034203</b>	175	40	175	225	0,44	30	1	pce
<b>1034204</b>	200	50	200	250	0,62	20	1	pce
<b>1090415</b>	250	50	250	300	0,79		1	pce

## Uponor Ecoflex repair sleeve

- Shrink sleeve to seal damages in casing pipe

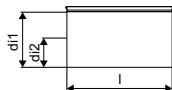

Item no.	Dimension	l mm	di1 mm	di2 mm	s mm	Weight kg	Qty 1	UOM
<b>1036014</b>	140+175+200-700mm	700	226	98	1,7	1,20	1	pce

# Uponor Ecoflex

## Uponor Ecoflex shrink tape

- Shrinkable tape use for sealing damaged casing pipes

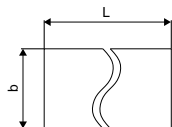
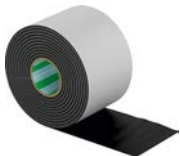

Item no.	Dimension	L m	b1 mm	Weight kg	Qty 2	Qty 1	UOM
<b>1093120</b>	160mm x 10m	10	160	2,40	30	1	pce

## Uponor Ecoflex trench warning tape, red

- For marking the position of buried Ecoflex pipes  
- Tape marking with required application symbols

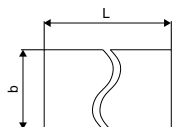

Item no.	Dimension	L m	b mm	Weight kg	Qty 1	UOM
<b>1018385</b>	40mm x 250m	250	40	2,00	1	pce

## Uponor Ecoflex uncoiler type1

- Support to decoiling the pipe  
- Max. load capacity of 650 kg



Item no.	Dimension	l mm	h mm	Weight kg	Qty 1	UOM
<b>1036645</b>		2400	1050	100,00	1	pce

## Uponor Multi pipe cutting tool

- outside diameters 25-63 mm



Item no.	Dimension	Qty 2	Qty 1	UOM
<b>1089675</b>	25-63	12	1	pce
<b>1089777</b>	25-63	blade (wheel)	50	1 pce

## Uponor Multi pipe cutting tool

- outside diameters 50-125 mm



Item no.	Dimension	Qty 2	Qty 1	UOM
<b>1089676</b>	50-125	8	1	pce
<b>1089778</b>	50-125	blade (wheel)	50	1 pce

## Uponor MLC deburring tool universal



Item no.	Dimension	Qty 2	Qty 1	UOM
<b>1060167</b>		50	1	pce



# Uponor Ecoflex

## Uponor Wipex sleeve plier

- Expansion tool for the WIPEX coupling sleeve



Item no.	Dimension	l mm	Weight kg	Qty 2	Qty 1	UOM
<b>1046407</b>	1 - 1 ½	145	0,15	25	1	pce
<b>1046408</b>	1 ½ - 3 ½	200	0,23	25	1	pce

## Uponor Q&E graphite paste, manual tools



Item no.	Dimension	Weight kg	Qty 1	UOM
<b>1008334</b>	30g	0,03	20	pce

## Uponor Q&E graphite paste



Item no.	Dimension	Weight kg	Qty 1	UOM
<b>1005017</b>	100g	0,10	1	pce

## Uponor Wipex O-ring PN 10

- Sealing ring for WIPEX Coupling Inner sleeve 10bar ISO A S3.2



Item no.	Dimension	d mm	Weight kg	Qty 1	UOM
<b>1026535</b>	14,0x1,78/25x3,5 PN10	25	0,00	1	pce
<b>1018605</b>	19,0x2,0/32x4,4 PN10	32	0,00	1	pce
<b>1018606</b>	23,5x2,5/40x5,5 PN10	40	0,00	1	pce
<b>1018607</b>	30,0x2,5/50x6,9 PN10	50	0,00	1	pce
<b>1018608</b>	39,3x2,6/63x8,6 PN10	63	0,00	1	pce
<b>1026578</b>	48,0x3/75x10,3 PN10	75	0,00	1	pce
<b>1026582</b>	58,0x3/90x12,3 PN10	90	0,00	1	pce
<b>1026583</b>	72,0x3/110x15,1 PN10	110	0,00	1	pce

## Uponor Wipex O-ring PN6

- Sealing ring for WIPEX coupling inner sleeve 6bar ISO A S5



Item no.	Dimension	d mm	Weight kg	Qty 1	UOM
<b>1026549</b>	17,17x1,78/25x2,3 PN6	25	0,00	1	pce
<b>1018598</b>	22x2,0/32x2,9 PN6	32	0,00	1	pce
<b>1018599</b>	27,0x2,5/40x3,7 PN6	40	0,00	100	1
<b>1018600</b>	34,3x2,5/50x4,6 PN6	50	0,00	1	pce
<b>1018601</b>	45,7x2,62/63x5,8 PN6	63	0,00	1	pce
<b>1018602</b>	54,2x3,0/75x6,8 PN6	75	0,00	1	pce
<b>1018603</b>	65,0x3,0/90x8,2 PN6	90	0,00	1	pce
<b>1018604</b>	80,0x3,0/110x10 PN6	110	0,00	1	pce

# Uponor Ecoflex

## Uponor Wipex O-ring

- Sealing ring for Wipex base fittings



Item no.	Dimension	d mm	d1 mm	s mm	DN inch	Weight kg	Qty 2	Qty 1	UOM
<b>1018595</b>	43,5x3,0/G1 ¼	43,5	32	3,0	1¼	0,00	100	1	pce
<b>1018596</b>	61,9x3,53/G2	61,9	50	3,53	2	0,00		1	pce
<b>1013306</b>	90,0X4,0/G3	90,0	80	4,0	3	0,00		1	pce
<b>1009105</b>	115,3X4,2/G4	115,3	100	4,2	4	0,00		1	pce

## Uponor Ecoflex sealing paste

- Material to seal the insulation set.



Item no.	Dimension	Weight kg	Qty 1	UOM
<b>1060996</b>	290ml	0,40	1	pce

## Uponor Ecoflex plastic spread rivet



Item no.	Dimension	Weight kg	Qty 1	UOM
<b>1021997</b>		0,00	1	pce

## Uponor Ecoflex screw set

- Screw set for H insulation set

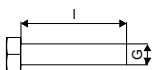

Item no.	Dimension	l mm	do mm	Weight kg	Qty 1	UOM
<b>1021999</b>		41	8	0,03	1	pce

## Uponor Ecoflex screw set

- Screw set for tee, elbow, straight insulation set

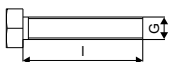

Item no.	Dimension	l mm	M mm	Weight kg	Qty 1	UOM
<b>1060995</b>	M6x30 (34pcs)	30	6	0,43	1	pce

## Uponor Ecoflex end cap clamping ring

- Clamp ring for rubber end cap



Item no.	Dimension	d mm	d2 mm	Weight kg	Qty 1	UOM
<b>1018319</b>	68	60-80	68	0,02	1	pce
<b>1018320</b>	90	80-100	90	0,03	1	pce
<b>1018318</b>	175	170-190	175	0,07	1	pce
<b>1018321</b>	200	190-210	200	0,08	1	pce

# Uponor Ecoflex

## Uponor Ecoflex end cap sealing ring

- Sealing ring used for the rubber end cap.



Item no.	Dimension	Weight kg	Qty 1	UOM
<b>1018659</b>	68	0,02	1	pce
<b>1018660</b>	90	0,02	1	pce

## Uponor Ecoflex swelling ring 2k

- Sealing ring used for the rubber end cap.



Item no.	Dimension	d2 mm	Weight kg	Qty 1	UOM
<b>1072157</b>	140	140/145	0,06	1	pce
<b>1072158</b>	175	175	0,07	1	pce
<b>1072159</b>	200	200	0,08	1	pce



# uponor

**Uponor GmbH**

P.O. Box 1641  
97433 Hassfurt  
Germany

**T** +49-(0)9521 690 0  
**F** +49-(0)9521 690 750  
**E** [international@uponor.com](mailto:international@uponor.com)

03/2022



[www.uponor.com](http://www.uponor.com)