

**Radiant heating & cooling,  
plumbing and  
local heat distribution**

**Uponor**

**Product Catalogue 03-2022  
Tap Water System INOX**

# Uponor INOX

The stainless steel Uponor press fitting system is the ideal solution for the creation of installations used to distribute drinking water, since stainless steel 1.4404 (AISI 316L) meets highest material requirements with

an excellent corrosion resistance.

Easy processing is guaranteed with the established M-contour and a press indicator foil on every fitting.

## Your benefits

- High quality EN 1.4404 stainless steel
- Operating pressure of 16 bar
- Press indication foil
- Unpressed – Untight function



## Specification

- The pipes and fittings are made of austenitic stainless Cr-Ni-Mo steel 1.4404 (AISI 316L)

## Application

- Tap water: The permanent operating temperature ranges from -20°C to 120°C at a maximum permanent operating pressure of 16 bar.

## Certification

- DVGW
- KIWA

## Uponor INOX pipe S

- Operating pressure PN16
- Bar

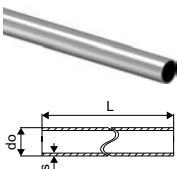

Item no.	Dimension	l mm	L m	do mm	s mm	Qty 2	Qty 1	UOM
1119058	15x1,0 6m	6000	6000	15	1,0	1014	6	m
1119059	18x1,0 6m	6000	6000	18	1,0	1014	6	m
1119060	22x1,2 6m	6000	6000	22	1,2	762	6	m
1119061	28x1,2 6m	6000	6000	28	1,2	546	6	m
1119062	35x1,5 6m	6000	6000	35	1,5	546	6	m
1119063	42x1,5 6m	6000	6000	42	1,5	366	6	m
1119064	54x1,5 6m	6000	6000	54	1,5	366	6	m

## Uponor INOX bend

- Stainless steel fitting
- Press indicator
- Compatible with press jaws type M

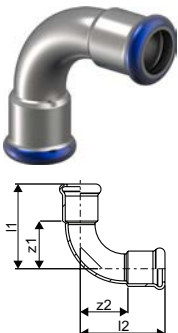

Item no.	Dimension	l1 mm	l2 mm	z1 mm	z2 mm	Qty 2	Qty 1	UOM
1119065	15-15	48	48	27	27	100	10	pce
1119066	18-18	53	53	32	32	80	1	pce
1119067	22-22	60	60	37	37	60	10	pce
1119068	28-28	71	71	47	47	30	10	pce
1119069	35-35	87	87	60	60	20	10	pce
1119070	42-42	115	115	83	83	8	2	pce
1119071	54-54	142	142	105	105	4	2	pce

# Uponor INOX

## Uponor INOX bend plain end

- Stainless steel fitting
- Press indicator
- Compatible with press jaws type M

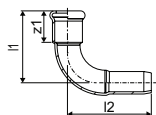

Item no.	Dimension	l1 mm	l2 mm	z1 mm	Qty 2	Qty 1	UOM
<b>1119072</b>	15-15	48	56	27	100	10	pce
<b>1119073</b>	18-18	53	62	32	80	10	pce
<b>1119074</b>	22-22	60	68	37	60	10	pce
<b>1119075</b>	28-28	71	80	47	30	10	pce
<b>1119076</b>	35-35	87	93	60	20	10	pce
<b>1119077</b>	42-42	115	125	83	8	2	pce
<b>1119078</b>	54-54	142	149	105	4	2	pce

## Uponor INOX bend 45

- Stainless steel fitting
- Press indicator
- Compatible with press jaws type M

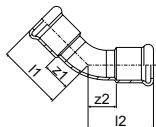

Item no.	Dimension	l1 mm	l2 mm	z1 mm	z2 mm	Qty 2	Qty 1	UOM
<b>1119079</b>	15-15	37	37	16	16	100	10	pce
<b>1119080</b>	18-18	38	38	17	17	100	10	pce
<b>1119081</b>	22-22	44	44	21	21	60	10	pce
<b>1119082</b>	28-28	51	51	27	27	40	10	pce
<b>1119083</b>	35-35	59	59	32	32	20	10	pce
<b>1119084</b>	42-42	77	77	45	45	12	4	pce
<b>1119085</b>	54-54	88	88	51	51	8	2	pce

## Uponor INOX bend 45 plain end

- Stainless steel fitting
- Press indicator
- Compatible with press jaws type M

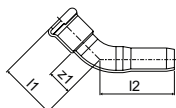

Item no.	Dimension	l1 mm	l2 mm	z1 mm	Qty 2	Qty 1	UOM
<b>1119086</b>	15-15	37	48	16	120	10	pce
<b>1119087</b>	18-18	38	45	17	100	10	pce
<b>1119088</b>	22-22	44	53	21	60	10	pce
<b>1119089</b>	28-28	51	60	27	40	10	pce
<b>1119090</b>	35-35	59	66	32	20	10	pce
<b>1119091</b>	42-42	77	80	45	12	4	pce
<b>1119092</b>	54-54	88	97	51	8	2	pce

# Uponor INOX

## Uponor INOX coupling

- Stainless steel fitting
- Press indicator
- Only compatible with press jaws type M

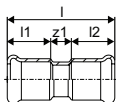

Item no.	Dimension	l mm	l1 mm	l2 mm	z1 mm	Qty 2	Qty 1	UOM
1119166	15-15	52	21	21	10	160	20	pce
1119167	18-18	53	21	21	11	100	10	pce
1119168	22-22	59	23	23	13	80	10	pce
1119169	28-28	61	24	24	13	60	10	pce
1119170	35-35	72	27	27	18	40	10	pce
1119171	42-42	80	30	30	20	24	4	pce
1119172	54-54	91	37	37	17	16	4	pce

## Uponor INOX reducer with plain end

- Stainless steel fitting
- Press indicator
- Only compatible with press jaws type M

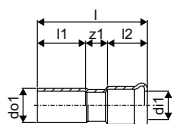

Item no.	Dimension	l mm	l1 mm	l2 mm	do1 mm	do2 mm	z1 mm	Qty 2	Qty 1	UOM
1119173	18-15	58	26	21	15	18	12	200	20	pce
1119174	22-15	60	26	21	15	22	14	100	10	pce
1119175	22-18	57	26	21	18	22	11	100	10	pce
1119176	28-15	74	30	21	15	28	23	80	10	pce
1119177	28-18	78	30	21	18	28	27	80	10	pce
1119178	28-22	67	28	23	22	28	17	80	10	pce
1119179	35-18	86	34	21	18	35	32	60	10	pce
1119180	35-22	77	34	23	22	35	20	60	10	pce
1119181	35-28	73	36	24	28	35	14	60	10	pce
1119182	42-18	101	38	21	18	42	42	50	10	pce
1119183	42-22	91	38	23	22	42	30	30	5	pce
1119184	42-28	99	35	24	28	42	40	30	5	pce
1119185	42-35	79	39	27	35	42	14	30	5	pce
1119186	54-28	100	48	24	28	54	28	20	5	pce
1119187	54-35	117	48	27	35	54	42	15	5	pce
1119188	54-42	97	44	32	42	54	22	20	5	pce

## Uponor INOX tee

- Stainless steel fitting
- Press indicator
- Compatible with press jaws type M

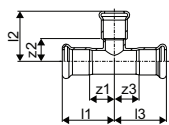

Item no.	Dimension	l1 mm	l2 mm	l3 mm	z1 mm	z2 mm	z3 mm	Qty 2	Qty 1	UOM
1119093	15-15-15	37	35	37	16	14	16	80	10	pce
1119094	18-18-18	40	35	40	19	14	19	60	10	pce
1119095	22-22-22	41	40	41	18	17	18	50	10	pce
1119096	28-28-28	46	45	46	22	21	22	30	10	pce
1119097	35-35-35	51	55	51	24	28	24	20	10	pce
1119098	42-42-42	59	61	59	27	29	27	12	4	pce
1119099	54-54-54	71	72	71	34	35	34	6	2	pce

# Uponor INOX

## Uponor INOX tee reducer

- Stainless steel fitting
- Press indicator
- Compatible with press jaws type M

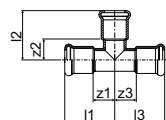

Item no.	Dimension	l1 mm	l2 mm	l3 mm	z1 mm	z2 mm	z3 mm	Qty 2	Qty 1	UOM
1119100	18-15-18	40	36	40	19	15	19	50	10	pce
1119101	22-15-22	41	39	41	18	18	18	50	10	pce
1119102	22-18-22	41	38	41	18	17	18	50	10	pce
1119103	28-15-28	46	42	46	22	21	22	30	10	pce
1119104	28-18-28	46	42	46	22	21	22	30	10	pce
1119105	28-22-28	46	45	46	22	22	22	30	10	pce
1119106	35-15-35	51	45	51	24	24	24	20	10	pce
1119107	35-18-35	51	45	51	24	24	24	20	10	pce
1119108	35-22-35	51	46	51	24	23	24	20	10	pce
1119109	35-28-35	51	48	51	24	24	24	20	10	pce
1119110	42-18-42	59	48	59	27	27	27	12	4	pce
1119111	42-22-42	59	51	59	27	28	27	12	4	pce
1119112	42-28-42	59	53	59	27	29	27	12	4	pce
1119113	42-35-42	59	60	59	27	33	27	12	4	pce
1119114	54-18-54	71	55	71	34	34	34	6	2	pce
1119115	54-22-54	71	57	71	34	34	34	8	2	pce
1119116	54-28-54	71	60	71	34	36	34	8	2	pce
1119117	54-35-54	71	66	71	34	39	34	6	2	pce
1119118	54-42-54	71	64	71	34	32	34	6	2	pce

## Uponor INOX tee female thread

- Stainless steel fitting
- Press indicator
- Compatible with press jaws type M

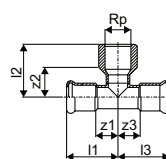

Item no.	Dimension	l1 mm	l2 mm	l3 mm	Rp inch	z1 mm	z2 mm	z3 mm	Qty 2	Qty 1	UOM
1119119	15-Rp $\frac{1}{2}$ "FT-15	37	37	37	$\frac{1}{2}$	16	25	16	80	10	pce
1119120	18-Rp $\frac{1}{2}$ "FT-18	40	39	40	$\frac{1}{2}$	19	27	19	60	10	pce
1119121	18-Rp $\frac{3}{4}$ "FT-18	40	43	40	$\frac{3}{4}$	19	30	19	50	10	pce
1119122	22-Rp $\frac{1}{2}$ "FT-22	41	41	41	$\frac{1}{2}$	18	29	18	50	10	pce
1119123	22-Rp $\frac{3}{4}$ "FT-22	41	41	41	$\frac{3}{4}$	18	28	18	40	10	pce
1119124	28-Rp $\frac{1}{2}$ "FT-28	46	44	46	$\frac{1}{2}$	22	32	22	30	10	pce
1119125	28-Rp $\frac{3}{4}$ "FT-28	46	45	46	$\frac{3}{4}$	22	32	22	30	10	pce
1119126	35-Rp $\frac{1}{2}$ "FT-35	51	48	51	$\frac{1}{2}$	24	36	24	20	10	pce
1119127	35-Rp $\frac{3}{4}$ "FT-35	51	48	51	$\frac{3}{4}$	24	35	24	20	10	pce
1119128	42-Rp $\frac{1}{2}$ "FT-42	59	46	59	$\frac{1}{2}$	27	34	27	16	2	pce
1119129	42-Rp $\frac{3}{4}$ "FT-42	59	52	59	$\frac{3}{4}$	27	39	27	16	4	pce
1119130	54-Rp $\frac{1}{2}$ "FT-54	71	55	71	$\frac{1}{2}$	34	43	34	8	2	pce
1119131	54-Rp $\frac{3}{4}$ "FT-54	71	58	71	$\frac{3}{4}$	34	45	34	6	2	pce
1119132	54-Rp2"FT-54	71	69	71	2	34	47	34	6	2	pce

# Uponor INOX

## Uponor INOX adapter male thread

- Stainless steel fitting
- Press indicator
- Compatible with press jaws type M

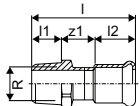

Item no.	Dimension	l mm	l1 mm	l2 mm	R inch	z1 mm	Qty 2	Qty 1	UOM
1119133	15xR1/2"MT	52	14	21	1/2	20	200	20	pce
1119134	15xR3/4"MT	64	15	21	3/4	29	100	10	pce
1119135	18xR1/2"MT	52	14	21	1/2	20	160	20	pce
1119136	18xR3/4"MT	54	15	21	3/4	21	100	10	pce
1119137	22xR1/2"MT	68	14	23	1/2	32	100	10	pce
1119138	22xR3/4"MT	58	15	23	3/4	20	80	10	pce
1119139	22xR1"MT	72	17	23	1	32	50	10	pce
1119140	28xR3/4"MT	73	15	24	3/4	36	60	10	pce
1119141	28xR1"MT	62	17	24	1	23	60	10	pce
1119142	35xR1"MT	82	17	27	1	39	40	10	pce
1119143	35xR1 1/4"MT	70	20	27	1 1/4	24	30	10	pce
1119144	42xR1 1/2"MT	75	20	32	1 1/2	24	24	4	pce
1119145	54xR2"MT	87	24	37	2	28	12	4	pce

## Uponor INOX adapter female thread

- Stainless steel fitting
- Press indicator
- Only compatible with press jaws type M

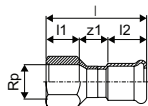

Item no.	Dimension	l mm	l1 mm	l2 mm	Rp inch	z1 mm	Qty 2	Qty 1	UOM
1119146	15xRp1/2"FT	55	15	21	1/2	19	120	10	pce
1119147	15xRp3/4"FT	67	17	21	3/4	30	90	10	pce
1119148	18xRp1/2"FT	52	15	21	1/2	16	120	20	pce
1119149	18xRp3/4"FT	59	17	21	3/4	21	100	10	pce
1119150	22xRp1/2"FT	52	15	23	1/2	14	100	10	pce
1119151	22xRp3/4"FT	57	17	23	3/4	17	80	10	pce
1119152	22xRp1"FT	71	19	23	1	29	60	10	pce
1119153	28xRp3/4"FT	74	17	24	3/4	33	60	10	pce
1119154	28xRp1"FT	63	19	24	1	20	60	10	pce
1119155	35xRp1"FT	82	19	27	1	36	30	10	pce
1119156	35xRp1 1/4"FT	71	21	27	1 1/4	23	30	10	pce
1119157	42xRp1 1/2"FT	75	21	32	1 1/2	22	24	6	pce
1119158	54xRp2"FT	86	26	37	2	23	12	4	pce

# Uponor INOX

## Uponor INOX flange PN16

- Stainless steel fitting
- Press indicator
- Only compatible with press jaws type M

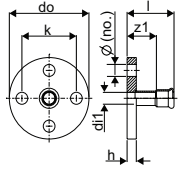

Item no.	Dimension	no. pce	l mm	di mm	do mm	z1 mm	h mm	k mm	M mm	p mm	bar	Qty 2	Qty 1	UOM
<b>1119159</b>	DN12-15 mm	4	54	14	95	33	11	65	14	16		15	1	pce
<b>1119160</b>	DN15-18 mm	4	57	17	95	36	11	65	14	16		10	1	pce
<b>1119161</b>	DN20-22 mm	4	61	21	105	37	12	75	14	16		10	1	pce
<b>1119162</b>	DN25-28 mm	4	65	27	115	41	14	85	14	16		5	1	pce
<b>1119163</b>	DN32-35 mm	4	70	32	140	43	15	100	18	16		4	1	pce
<b>1119164</b>	DN40-42 mm	4	78	39	150	47	16	110	18	16		5	1	pce
<b>1119165</b>	DN50-54 mm	4	87	51	165	51	18	125	18	16		2	1	pce





# uponor

**Uponor GmbH**

P.O. Box 1641  
97433 Hassfurt  
Germany

**T** +49-(0)9521 690 0  
**F** +49-(0)9521 690 750  
**E** [international@uponor.com](mailto:international@uponor.com)

03/2022



[www.uponor.com](http://www.uponor.com)